

**NOTES:**

1. REFER TO JOHNS MANVILLE WEBSITE ([www.jm.com](http://www.jm.com)) FOR MOST UP-TO-DATE INFORMATION.
2. PLEASE SEE PVC SYSTEM FLASHING SPECIFICATIONS FOR A FULL DESCRIPTION OF INSTALLATION INSTRUCTIONS AND REQUIREMENTS WHICH ARE CONSIDERED A PART OF THIS DETAIL.
3. ANY CARPENTRY OR METAL WORK SHOULD BE DESIGNED AND CONSTRUCTED IN ACCORDANCE WITH LOCAL CODE REQUIREMENTS AND/OR PROJECT SPECIFICATIONS. THESE COMPONENTS SHOULD BE REVIEWED AND APPROVED BY A LICENSED DESIGN PROFESSIONAL. CONTACT JM TECHNICAL FOR METAL OPTIONS TO BE INCLUDED WITHIN THE JM NDL GUARANTEE.
4. JM PVC EDGE SEALANT IS NOT REQUIRED ON ALL CUT OR NON-ENCAPSULATED EDGES OF REINFORCED MEMBRANE. THIS INCLUDES FACTORY CUT MEMBRANE.
5. FOR JM APPROVED BASE FLASHING FASTENING METHODS SEE PH-FW-B DETAILS. A SUFFICIENT BACKER FASTENING STRIP MUST BE INSTALLED BEHIND SUBSTRATES DIRECTLY TO STUDS FOR INSTALLATION OF TERMINATION BARS AND FLASHINGS WHEN SUBSTRATES WILL NOT SUPPORT A PROPER, SECURE INSTALLATION. SEE DETAIL PH-FW-M2I FOR BACKER DETAIL.

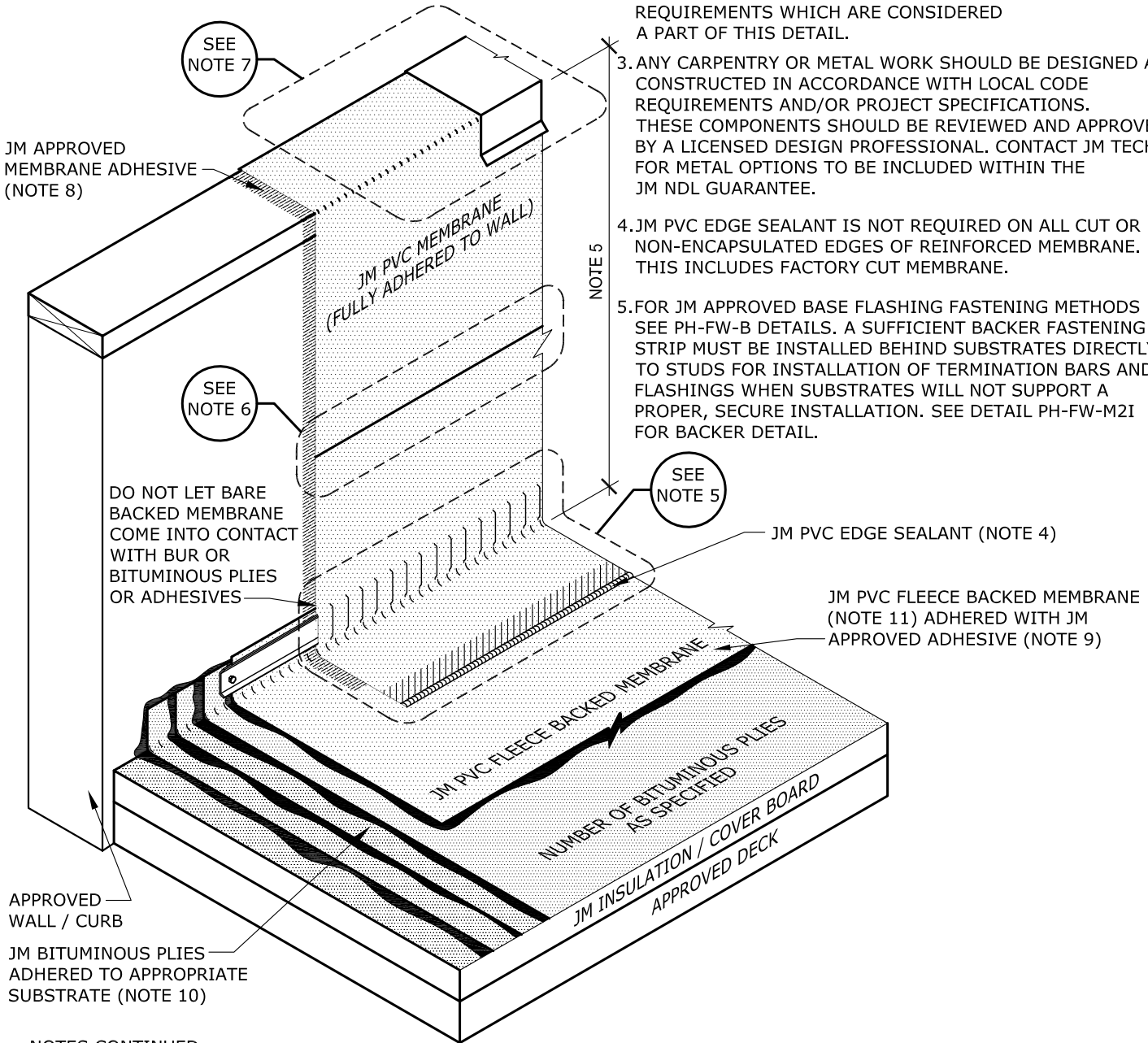

**NOTES CONTINUED:**

6. FOR JM APPROVED INTERMEDIATE FLASHING FASTENING METHODS SEE P-FW-I DETAILS. MINIMUM FLASHING TERMINATION HEIGHT IS 8" ABOVE ROOF SURFACE. INTERMEDIATE ADHERED MEMBRANE FASTENING REQUIRED AT 5'-0" INTERVALS MAXIMUM, AND 18" HIGH MAXIMUM FOR NON ADHERED MEMBRANE ON CMU, BRICK, SMOOTH CONCRETE WALLS, OR ANY JM APPROVED SUBSTRATE, IE. PLYWOOD, GLASS FACED GYPSUM OR JM INVINSA. SEE DETAIL PH-FW-M2I FOR JM APPROVED FASTENING METHODS.
7. FOR JM APPROVED TOP OF WALL FLASHING METHODS SEE P-FW-T DETAILS.
8. JM APPROVED ADHESIVES FOR USE ON VERTICAL FLASHING APPLICATIONS INCLUDES JM PVC MEMBRANE ADHESIVES (LOW VOC).
9. JM APPROVED ADHESIVES FOR JM PVC FLEECE BACKED MEMBRANE ADHERED OVER BITUMINOUS PLIES INCLUDES HOT ASPHALT, RSUA OR 2P UIA CANISTER.
10. JM BITUMINOUS PLIES INCLUDE APPROPRIATE SMOOTH SBS MODIFIED BITUMEN SHEETS APPLIED WITH HOT ASPHALT, MBR COLD APPLICATION ADHESIVE, OR HEAT WELDED TECHNIQUES, AND/OR PLY FELTS APPLIED IN HOT ASPHALT.
11. JM PVC FLEECE BACKED MEMBRANE OPTIONS INCLUDE JM PVC FB WITH DOW™ ELVALOY® KEE POLMER AND JM PVC SD PLUS FB.

DRAWING NO.

**PH-FW-M1I**

**PVC HYBRID BASE & WALL FLASHING WITH COPING ISOMETRIC VIEW**

MEMBRANE TYPE:

**JM PVC FLEECE BACK HYBRID**

Johns Manville is a manufacturer of commercial roofing products and offers this general conceptual information to you as a courtesy. This complimentary assistance is not to be used or relied upon by anyone as a substitute for professional engineering design and documentation required by building code, contract, or applicable law. By accepting these comments you agree they do not constitute any representations, endorsements of, or an assumption by Johns Manville of any liability for either the adequacy of the design of this building or any other material not supplied by Johns Manville.

SCALE

N.T.S

ISSUE DATE

12-07-23

MAXIMUM GUARANTEE TERM:

20 YEAR

