



A TPO SYSTEM DESIGN TO STAND UP TO VERY SEVERE HAIL (VSH)

OVER DENSDECK® STORMX™ ROOF BOARD

MORE PROTECTION. MORE PRODUCTIVITY.

EASIER TO INSTALL

Flexibility to use your preferred JM TPO adhesive lets you work your way.

INNOVATING TPO AGAINST HAIL

Now in both:

*Mechanically Fastened JM TPO FB System and
Adhered Bare-Backed TPO System
Over DensDeck® StormX™ Roof Board*

VERY SEVERE HAIL STRONG

*To withstand the harshest
conditions over the long haul.*



BE PREPARED FOR THE WORST HAIL STRIKES.

Through the majority of the United States, hailstorms are common, move fast and can cause heavy damage to roofs. Although they may be unpredictable, you can count on JMTPO to resist the most dangerous storms.

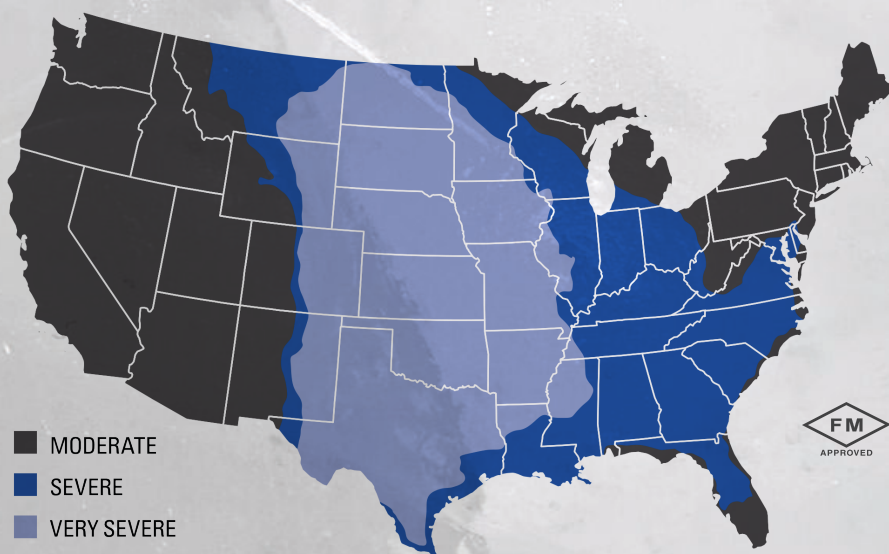

MODERATE HAIL APPROVAL
UPTO 1" (QUARTER SIZE)



SEVERE HAIL APPROVAL
UPTO 1¾" (GOLF BALL SIZE)



VERY SEVERE HAIL APPROVAL
GREATER THAN 2" (EIGHT BALL SIZE)

WE ACHIEVED THE INDUSTRY'S TOUGHEST HAIL RATING. PERIOD.

A building is an investment and deserves to be well-protected. With our Very Severe Hail (VSH) rating, save money and rest assured knowing the roof has been successfully tested to meet the FM's Very Severe Hail Rating, which includes hail exceeding 2" and falling at speeds up to 72 mph.



Mechanically Fastened System

1. JM TPO FB 175 10'
2. High Load Fasteners and Plates
8" wide lap (fleece covers the plates)
3. DensDeck® StormX™ Prime Roof Board
Preliminarily Fastened
4. UltraFast® Fasteners and *APB Plates*
5. ENRGY 3® Insulation
(Loose Laid)
6. Steel Deck

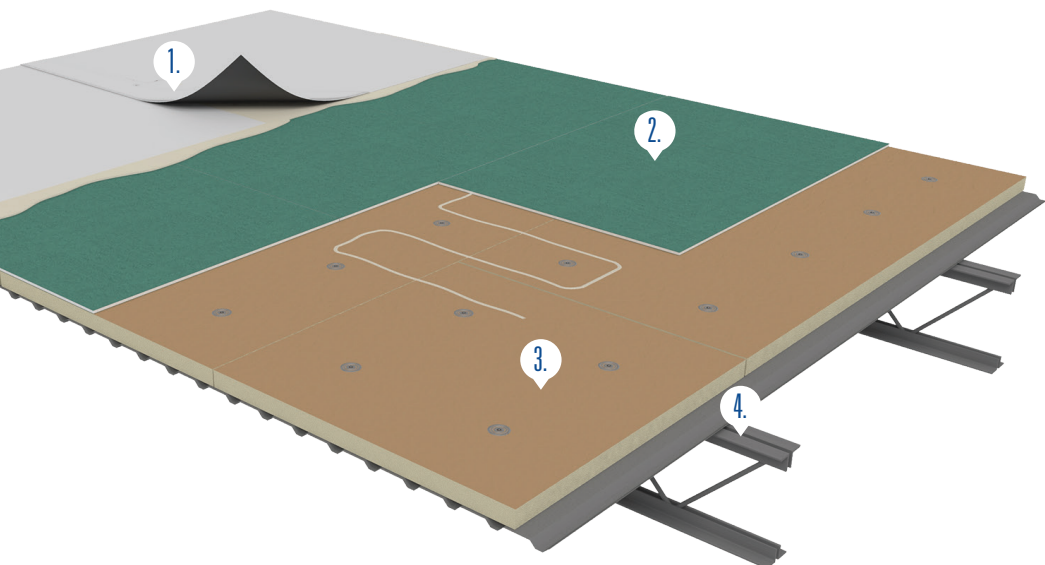
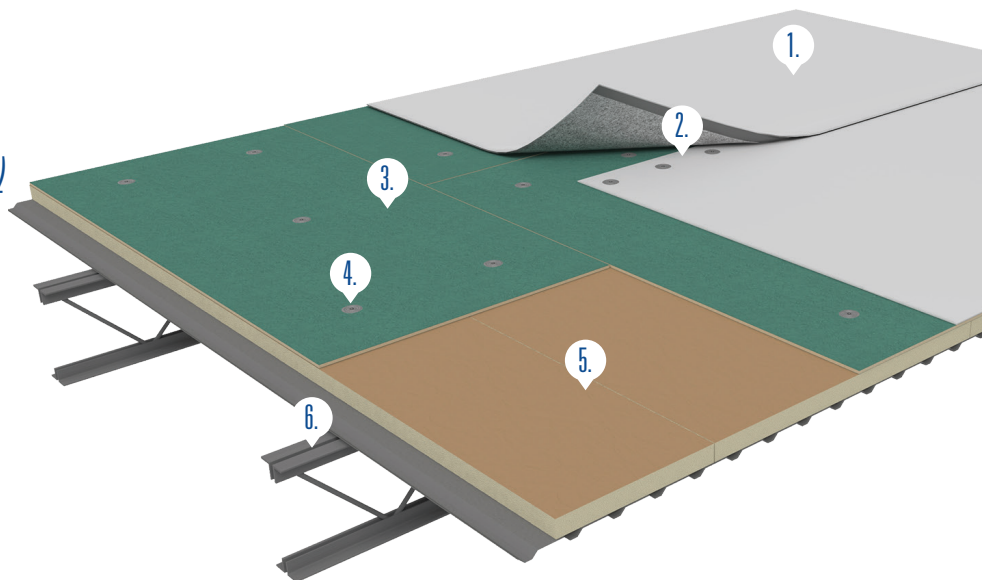

Adhered System

1. JM 60 mil TPO
(Adhered with JM Approved TPO Adhesive)
2. DensDeck® StormX™ Prime Roof Board
(Adhered with JM RSUA or JM 2-Part UIA 12" o.c.)
3. ENRGY® 3 Insulation
(Mechanically Fastened)
4. Steel Deck

ADHERED

467070-0-0	60 MIL TPO	ALL-SEASON & WATER-BASED
467075-0-0	60 MIL TPO	SOLVENT-BASED
467080-0-0	60 MIL TPO	LVOC & ALL-SEASON

MECHANICALLY FASTENED

537149-0-0	TPO FB 175 10'	12" O.C. I-75
537041-0-0	TPO FB 175 10'	6" O.C. I-90
537158-0-0	TPO FB 175 10'	12" O.C. I-75 (RECOVER)

OUR MOST POPULAR
**VSH
ASSEMBLIES**