

DO NOT LET BARE BACKED TPO MEMBRANE COME INTO CONTACT WITH BUR OR BITUMINOUS PLIES OR ADHESIVES

2 SELF TAPPING FASTENERS PER STUD (TYPICAL)

METAL STUDS (TYPICAL)

6" WIDE 22 GA. SHEET METAL BACKER FASTENING STRIP

APPROPRIATE JM FASTENERS 12" O.C. THROUGH METAL BACKER STRIP

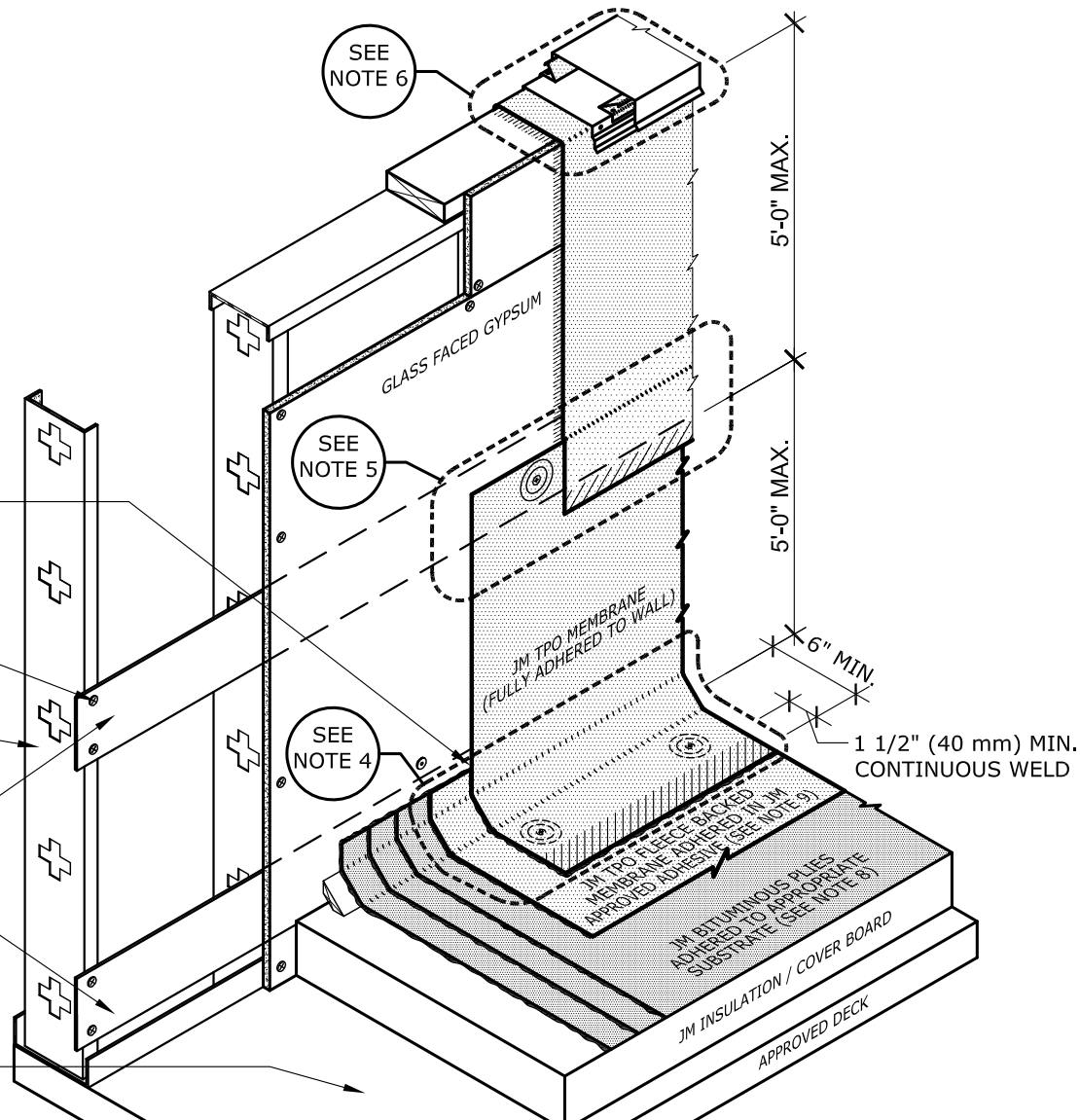

SEE NOTE 6

SEE NOTE 5

SEE NOTE 4

5'-0" MAX.

5'-0" MAX.

6" MIN.

1 1/2" (40 mm) MIN. CONTINUOUS WELD

**NOTES:**

1. REFER TO JOHNS MANVILLE WEBSITE ([www.jm.com](http://www.jm.com)) FOR MOST UP-TO-DATE INFORMATION.
2. PLEASE SEE SINGLE PLY FLASHING SPECIFICATIONS FOR A FULL DESCRIPTION OF INSTALLATION INSTRUCTIONS AND REQUIREMENTS WHICH ARE CONSIDERED A PART OF THIS DETAIL.
3. ANY CARPENTRY OR METAL WORK SHOULD BE DESIGNED AND CONSTRUCTED IN ACCORDANCE WITH LOCAL CODE REQUIREMENTS AND/OR PROJECT SPECS. THESE COMPONENTS SHOULD BE REVIEWED AND APPROVED BY A LICENSED DESIGN PROFESSIONAL. CONTACT JM TECHNICAL FOR METAL OPTIONS TO BE INCLUDED WITHIN THE JM NDL GUARANTEE.
4. FOR JM APPROVED BASE FLASHING FASTENING METHODS SEE TH-FW-B DETAILS. A SUFFICIENT BACKER FASTENING STRIP MUST BE INSTALLED BEHIND SUBSTRATES DIRECTLY TO STUDS FOR INSTALLATION OF TERMINATION BARS AND FLASHINGS WHEN SUBSTRATES WILL NOT SUPPORT A PROPER, SECURE INSTALLATION. SEE DETAIL TH-FW-M2I FOR BACKER DETAIL.
5. FOR JM APPROVED INTERMEDIATE FLASHING FASTENING METHODS SEE T-FW-I DETAILS. MINIMUM FLASHING TERMINATION HEIGHT IS 8" ABOVE ROOF SURFACE. INTERMEDIATE ADHERED MEMBRANE FASTENING REQUIRED AT 5'-0" INTERVALS MAXIMUM, AND 18" HIGH MAXIMUM FOR NON ADHERED MEMBRANE ON CMU, BRICK, SMOOTH CONCRETE WALLS, OR ANY JM APPROVED SUBSTRATE, IE. PLYWOOD, GLASS FACED GYPSUM OR JM INVINSA. SEE DETAIL TH-FW-M2I FOR JM APPROVED FASTENING METHODS.
6. FOR JM APPROVED TOP OF WALL FLASHING METHODS SEE T-FW-T DETAILS.
7. JM APPROVED ADHESIVES FOR USE ON VERTICAL FLASHING APPLICATIONS INCLUDES JM LVOC MEMBRANE ADHESIVE (TPO & EPDM), JM MEMBRANE BONDING ADHESIVE (TPO & EPDM) AND TPO WATER BASED MEMBRANE ADHESIVE.
8. JM BITUMINOUS PLYES INCLUDE APPROPRIATE SMOOTH SBS MODIFIED BITUMEN SHEETS APPLIED WITH HOT ASPHALT, MBR COLD APPLICATION ADHESIVE, OR HEAT WELDED TECHNIQUES, AND/OR PLY FELTS APPLIED IN HOT ASPHALT.
9. JM APPROVED ADHESIVES FOR JM TPO FLEECE BACKED MEMBRANE ADHERED OVER BITUMINOUS PLYES INCLUDE HOT ASPHALT, RSUA OR 2P UIA CANISTER.
10. JM TPO EDGE SEALANT IS REQUIRED ON ALL CUT OR NON-ENCAPSULATED EDGES OF REINFORCED MEMBRANE. THIS INCLUDES FACTORY CUT MEMBRANE. SEE DETAIL T-MS-01.

DRAWING NO.

**TH-FW-M2I**

**HIGHWALL FLASHING WITH METAL BACKING STRIP ISOMETRIC VIEW**

MEMBRANE TYPE:  
JM TPO FLEECE BACK HYBRID

Johns Manville is a manufacturer of commercial roofing products and offers this general conceptual information to you as a courtesy. This complimentary assistance is not to be used or relied upon by anyone as a substitute for professional engineering design and documentation required by building code, contract, or applicable law. By accepting these comments you agree they do not constitute any representations, endorsements of, or an assumption by Johns Manville of any liability for either the adequacy of the design of this building or any other material not supplied by Johns Manville.

SCALE  
N.T.S

ISSUE DATE  
03-06-19

MAXIMUM GUARANTEE TERM:  
20 YEAR

