

JM DOES NOT EVALUATE OR RECOMMEND ANY LIGHTNING PROTECTION MANUFACTURERS PRODUCTS. THE LIGHTNING PROTECTION DEVICES SHOWN ARE FOR GRAPHIC REPRESENTATION ONLY AND ARE NOT COVERED UNDER ANY JM GUARANTEE.

LIGHTNING CABLE & CLAMP

SET BASE PLATE INTO BED OF TPO COMPATIBLE SEALANT

JM MEMBRANE PRIMER
SEE NOTE 7

JM PEEL & STICK COVER TAPE
(RECOMMENDED)

JM TPO FIELD MEMBRANE
ADHERED OR
MECHANICALLY FASTENED

JM TPO MEMBRANE
ADHESIVE (FOR ADHERED
SPECIFICATIONS ONLY)

JM PEEL & STICK
COVER TAPE
(RECOMMENDED)

FIELD MEMBRANE

LIGHTNING ROD, CABLE AND
FASTENERS BY OTHERS

LIGHTNING ROD AND BASE

SET BASE PLATE INTO BED OF
TPO COMPATIBLE SEALANT

JM TPO PEEL & STICK
COVER TAPE (RECOMMENDED)

JM TPO MEMBRANE PRIMER

JM TPO FIELD MEMBRANE
ADHERED OR
MECHANICALLY FASTENED

JM TPO MEMBRANE ADHESIVE
(FOR ADHERED
SPECIFICATIONS ONLY)

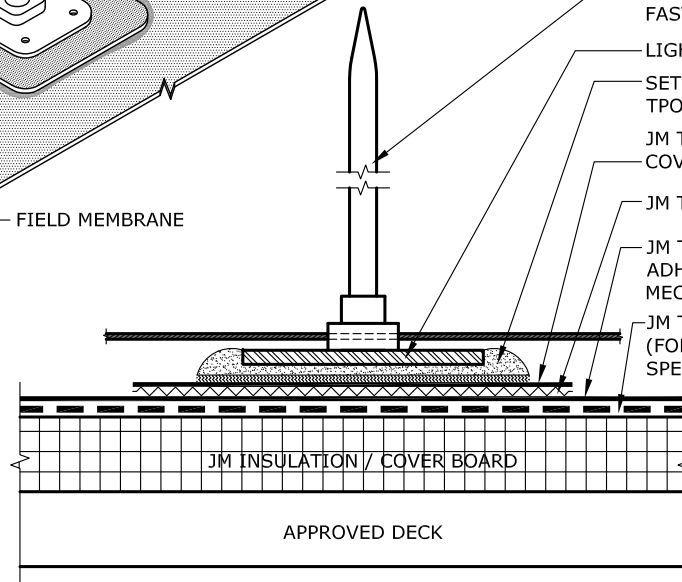
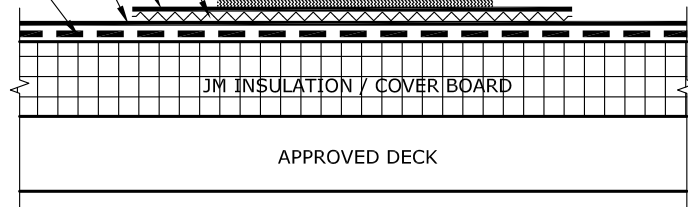

NOTES:

1. REFER TO JOHNS MANVILLE WEBSITE (www.jm.com) FOR MOST UP-TO-DATE INFORMATION.
2. PLEASE SEE SINGLE PLY FLASHING SPECIFICATIONS FOR A FULL DESCRIPTION OF INSTALLATION INSTRUCTIONS AND REQUIREMENTS WHICH ARE CONSIDERED A PART OF THIS DETAIL.
3. ANY CARPENTRY OR METAL WORK SHOULD BE DESIGNED AND CONSTRUCTED IN ACCORDANCE WITH LOCAL CODE REQUIREMENTS AND/OR PROJECT SPECIFICATIONS. THESE COMPONENTS SHOULD BE REVIEWED AND APPROVED BY A LICENSED DESIGN PROFESSIONAL. JM ASSUMES NO RESPONSIBILITY FOR THE INSTALLATION OF LIGHTNING RODS AND ASSOCIATED COMPONENTS OR FOR DAMAGE TO THE ROOF SYSTEM DUE TO FAULTY INSTALLATION OR DETACHMENT FROM SAID SYSTEM.
4. JM TPO EDGE SEALANT IS REQUIRED ON ALL CUT OR NON-ENCAPSULATED EDGES OF REINFORCED MEMBRANE. THIS INCLUDES FACTORY CUT MEMBRANE (SEE DETAIL T-MS-01).
5. LIGHTNING ROD GROUND WIRE MUST NOT COME IN CONTACT WITH THE ROOFING MEMBRANE. A SACRIFICIAL LAYER OF MEMBRANE IS RECOMMENDED UNDER THE ENTIRE LENGTH OF GROUND WIRE(S).
6. ALL SEALANTS / CAULKING SHALL BE PERIODICALLY INSPECTED AND MAINTAINED BY THE BUILDING OWNER THROUGHOUT THE LIFE OF THE ROOF.
7. PRIME UNDERSIDE OF FIELD MEMBRANE AT PEEL & STICK SECTION WITH JM TPO MEMBRANE PRIMER OR JM SINGLE PLY MEMBRANE PRIMER (LOW VOC). ROLL TPO MEMBRANE WITH ROLLER UNDER PRESSURE AT PEEL & STICK SECTION OF RTS.

LIGHTNING ROD (ROOF MOUNT)

DRAWING NO.

T-PT-09

REPLACES TM-95 & TM-96

MEMBRANE TYPE:

JM TPO

MAXIMUM GUARANTEE TERM:

N/A

ISSUE DATE

7-14-17

SCALE

N.T.S

Johns Manville is a manufacturer of commercial roofing products and offers this general conceptual information to you as a courtesy. This complimentary assistance is not to be used or relied upon by anyone as a substitute for professional engineering design and documentation required by building code, contract, or applicable law. By accepting these comments you agree they do not constitute any representations, endorsements of, or an assumption by Johns Manville of any liability for either the adequacy of the design of this building or any other material not supplied by Johns Manville.

