

INSTALL MEMBRANE DOWN  
OUTSIDE FACE OF WALL  
FASTEN 12" (305 mm) MAX.  
WITH APPROPRIATE FASTENERS

JM TPO FLEECE BACKED  
MEMBRANE ADHERED  
WITH JM RSUA

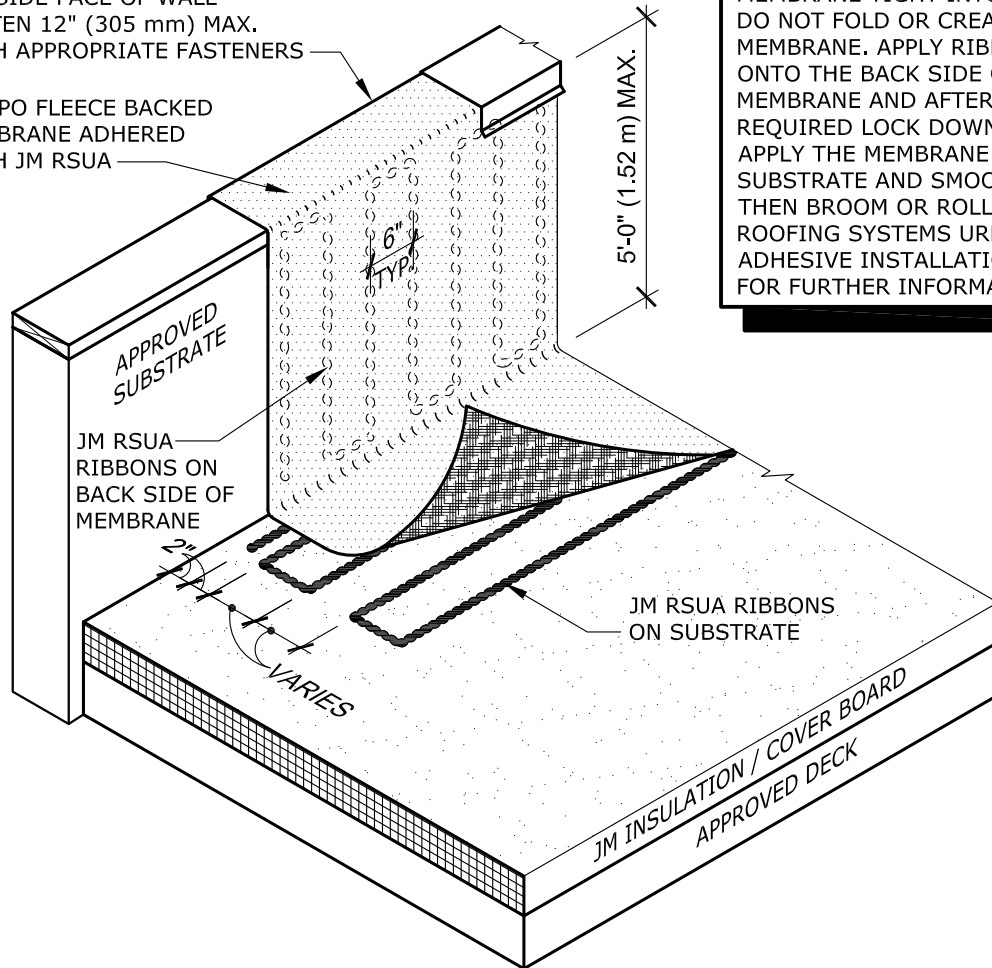

JM RSUA (ROOFING SYSTEMS URETHANE ADHESIVE) IS APPLIED TO THE SUBSTRATE ON HORIZONTAL SURFACES, AND TO THE BACK OF THE MEMBRANE FOR VERTICAL SURFACES.

IMMEDIATELY AFTER APPLYING THE FINAL RIBBONS OF RSUA ONTO THE HORIZONTAL SUBSTRATE, SET A WOOD 2 X INTO THE CORNER AND PUSH THE MEMBRANE TIGHT INTO THE CORNER. DO NOT FOLD OR CREATE THE MEMBRANE. APPLY RIBBONS OF RSUA ONTO THE BACK SIDE OF THE VERTICAL MEMBRANE AND AFTER THE PROPER REQUIRED LOCK DOWN/TACK FREE TIME APPLY THE MEMBRANE TO THE VERTICAL SUBSTRATE AND SMOOTH IN BY HAND THEN BROOM OR ROLL IT IN. SEE THE JM ROOFING SYSTEMS URETHANE ADHESIVE INSTALLATION INSTRUCTIONS FOR FURTHER INFORMATION.

**NOTES:**

1. REFER TO JOHNS MANVILLE WEBSITE ([www.jm.com](http://www.jm.com)) FOR MOST UP-TO-DATE INFORMATION.
2. PLEASE SEE SINGLE PLY FLASHING SPECIFICATIONS FOR A FULL DESCRIPTION OF INSTALLATION INSTRUCTIONS AND REQUIREMENTS WHICH ARE CONSIDERED A PART OF THIS DETAIL.
3. ANY CARPENTRY OR METAL WORK SHOULD BE DESIGNED AND CONSTRUCTED IN ACCORDANCE WITH LOCAL CODE REQUIREMENTS AND/OR PROJECT SPECIFICATIONS. THESE COMPONENTS SHOULD BE REVIEWED AND APPROVED BY A LICENSED DESIGN PROFESSIONAL. CONTACT JM TECHNICAL FOR METAL OPTIONS TO BE INCLUDED WITHIN THE JM NDL GUARANTEE.
4. JM TPO EDGE SEALANT IS REQUIRED ON ALL CUT OR NON-ENCAPSULATED EDGES OF REINFORCED MEMBRANE. THIS INCLUDES FACTORY CUT MEMBRANE (SEE DETAIL T-MS-01).
5. A SUFFICIENT BACKER FASTENING STRIP MUST BE INSTALLED BEHIND SUBSTRATES DIRECTLY TO STUDS FOR INSTALLATION OF TERMINATION BARS AND FLASHINGS WHEN SUBSTRATES WILL NOT SUPPORT A PROPER, SECURE INSTALLATION. SEE DETAIL T-FW-M2I FOR BACKER DETAIL.
6. FOR JM APPROVED INTERMEDIATE FLASHING FASTENING METHODS SEE T-FW-I DETAILS. MINIMUM FLASHING TERMINATION HEIGHT IS 8" (203 mm) ABOVE ROOF SURFACE. INTERMEDIATE ADHERED MEMBRANE FASTENING REQUIRED AT 5'-0" (1.52 m) INTERVALS MAXIMUM, AND 18" (457 mm) HIGH MAXIMUM FOR NON ADHERED MEMBRANE ON CMU, BRICK, SMOOTH CONCRETE WALLS, OR ANY JM APPROVED SUBSTRATE, IE. PLYWOOD, SECUROCK® GYPSUM-FIBER AND DENSDECK®. SEE DETAIL T-FW-M2I FOR JM APPROVED FASTENING METHODS.
7. FOR JM APPROVED TOP OF WALL FLASHING METHODS SEE T-FW-T DETAILS.

DRAWING NO.  
**T-FW-B13I**  
NEW DETAIL

**TPO FLEECE BACKED IN RSUA BASE & WALL FLASHING**

MEMBRANE TYPE:  
JM TPO FLEECE BACKED

SCALE  
N.T.S

ISSUE DATE  
10-12-18

MAXIMUM GUARANTEE TERM:  
N/A

Johns Manville is a manufacturer of commercial roofing products and offers this general conceptual information to you as a courtesy. This complimentary assistance is not to be used or relied upon by anyone as a substitute for professional engineering design and documentation required by building code, contract, or applicable law. By accepting these comments you agree they do not constitute any representations, endorsements of, or an assumption by Johns Manville of any liability for either the adequacy of the design of this building or any other material not supplied by Johns Manville.

