

WALL/CURB ATTACHMENT

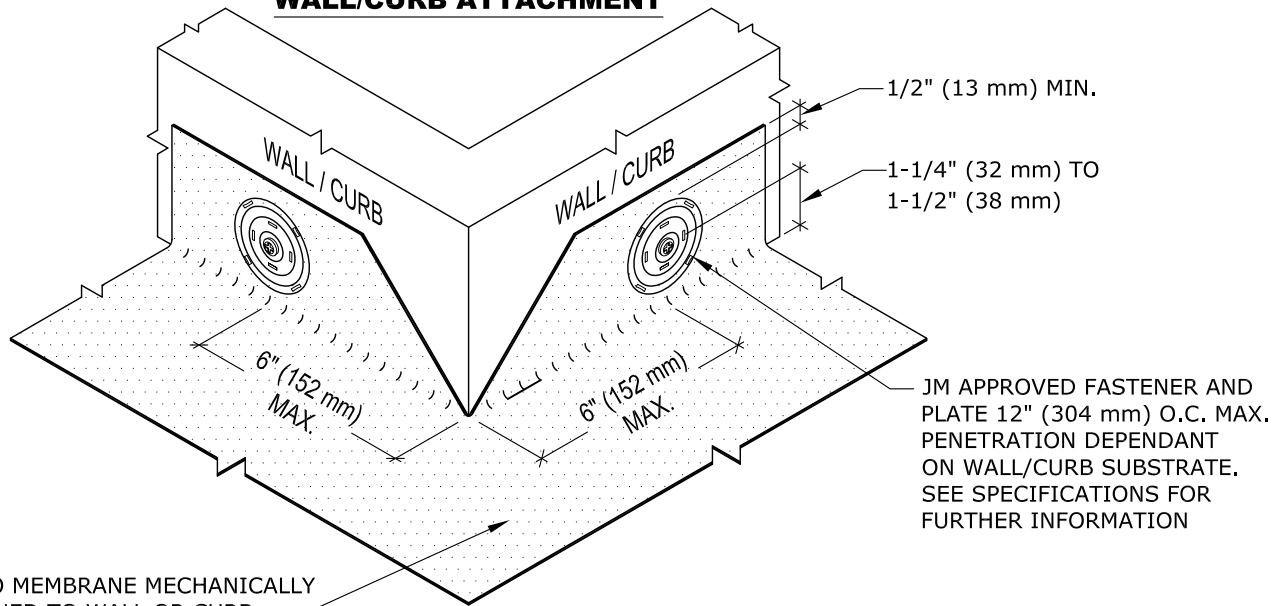

JM TPO MEMBRANE MECHANICALLY FASTENED TO WALL OR CURB

DECK ATTACHMENT

JM APPROVED FASTENER AND PLATE 12" (304 mm) O.C. MAX. PENETRATION DEPENDANT ON DECK MATERIAL(S). SEE SPECIFICATIONS FOR FURTHER INFORMATION

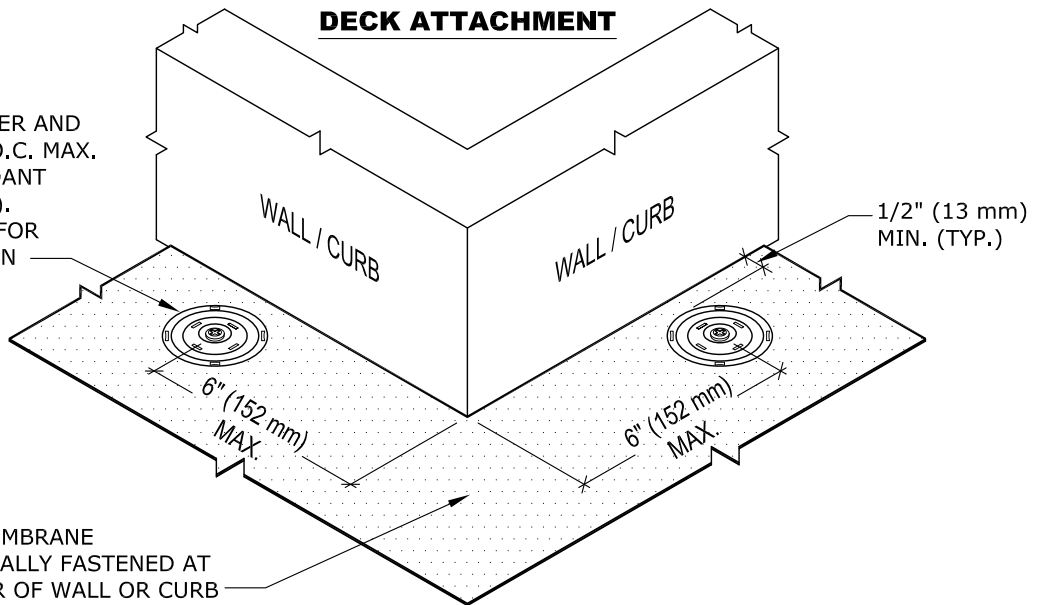

JM TPO MEMBRANE MECHANICALLY FASTENED AT PERIMETER OF WALL OR CURB

NOTES:

1. REFER TO JOHNS MANVILLE WEBSITE (www.jm.com) FOR MOST UP-TO-DATE INFORMATION.
2. PLEASE SEE SINGLE PLY FLASHING SPECIFICATIONS FOR A FULL DESCRIPTION OF INSTALLATION INSTRUCTIONS AND REQUIREMENTS WHICH ARE CONSIDERED A PART OF THIS DETAIL.
3. ANY CARPENTRY OR METAL WORK SHOULD BE DESIGNED AND CONSTRUCTED IN ACCORDANCE WITH LOCAL CODE REQUIREMENTS AND/OR PROJECT SPECIFICATIONS. THESE COMPONENTS SHOULD BE REVIEWED AND APPROVED BY A LICENSED DESIGN PROFESSIONAL.
4. JM TPO EDGE SEALANT IS REQUIRED ON ALL CUT OR NON ENCAPSULATED EDGES OF REINFORCED MEMBRANE. THIS INCULDES FACTORY CUT MEMBRANE (SEE DETAIL T-MS-01).

DRAWING NO.

T-FC-07

CURB & CORNER

MEMBRANE ATTACHMENT OUTSIDE CORNER

MEMBRANE TYPE:
JM TPO

MAXIMUM GUARANTEE TERM:
30 YEAR

Johns Manville is a manufacturer of commercial roofing products and offers this general conceptual information to you as a courtesy for general educational purposes only. This complimentary assistance is not to be either used or relied upon by anyone as a substitute for professional engineering design and documentation required by any building code, contract, or applicable law. By accepting the general conceptual information, you agree it does not constitute any representations, endorsements of, or an assumption by Johns Manville of any duty or liability for either the adequacy of the design of a building, any of its components or the sufficiency of any construction.



SCALE
N.T.S

ISSUE DATE
12-12-22