

REVERSE VIEW
METAL SCUPPER W/
COLLECTION BOX

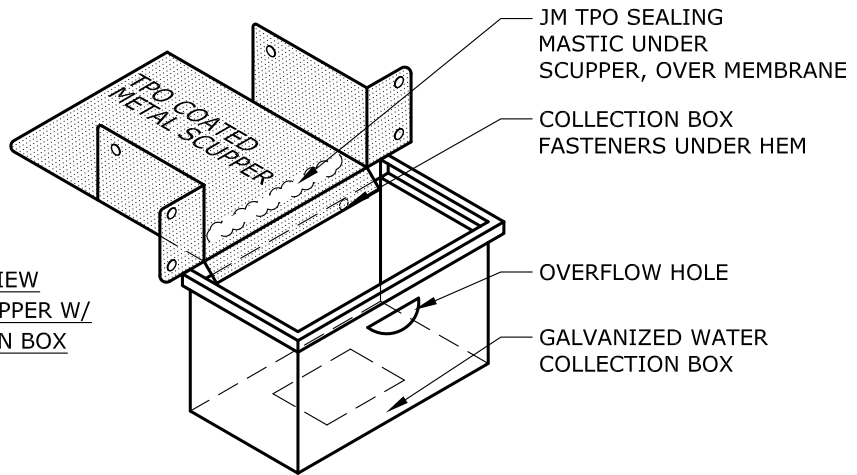

FABRICATED
FROM JM
TPO COATED METAL

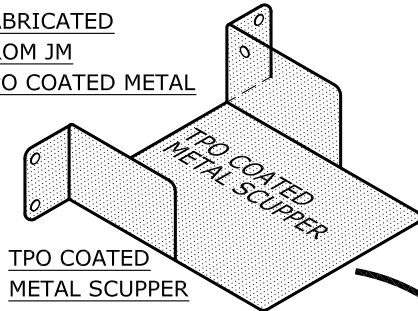

PRESTO-TITE
FASCIA COVER

PRESTO-TITE
ANCHOR BAR

SET SCUPPER FLANGES
INTO BED OF JM SINGLE
PLY SEALING MASTIC

INSTALL JM TPO
MEMBRANE UP & OVER
WOOD BLOCKING

CLEAT FASTENED PER
SMACNA, NRCA OR
JM SPECIFICATIONS

JM LVOC MEMBRANE
ADHESIVE (TPO & EPDM)

JM TPO WALL
FLASHING

WOOD BLOCKING AS
REQUIRED FASTENED
TO DECK

JM APPROVED FASTENER AND
PLATE-PENETRATION DEPENDANT
ON DECK MATERIAL(S). SEE
SPECIFICATIONS FOR FURTHER
INFORMATION

APPROPRIATE
FASTENERS

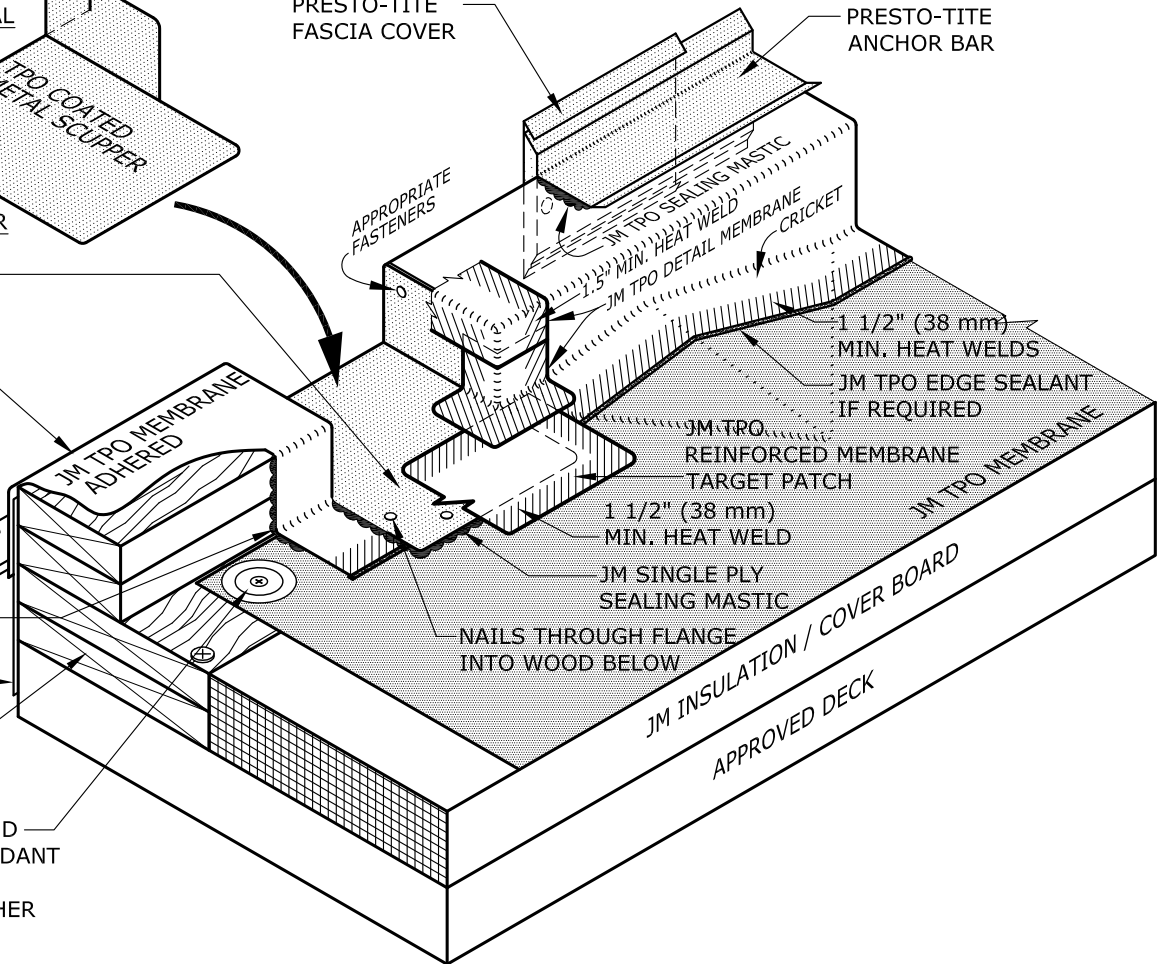

1 1/2" (38 mm)
MIN. HEAT WELDS
JM TPO SEALING MASTIC
JM TPO DETAIL MEMBRANE
CRICKET
JM TPO EDGE SEALANT
IF REQUIRED

1 1/2" (38 mm)
MIN. HEAT WELD
JM TPO REINFORCED MEMBRANE
TARGET PATCH
JM SINGLE PLY
SEALING MASTIC

NAILS THROUGH FLANGE
INTO WOOD BELOW

JM TPO MEMBRANE
JM TPO MEMBRANE
JM INSULATION / COVER BOARD
APPROVED DECK

NOTES:

1. REFER TO JOHNS MANVILLE WEBSITE (www.jm.com) FOR MOST UP-TO-DATE INFORMATION.
2. PLEASE SEE SINGLE PLY FLASHING SPECIFICATIONS FOR A FULL DESCRIPTION OF INSTALLATION INSTRUCTIONS AND REQUIREMENTS WHICH ARE CONSIDERED A PART OF THIS DETAIL.
3. ANY CARPENTRY OR METAL WORK SHOULD BE DESIGNED AND CONSTRUCTED IN ACCORDANCE WITH LOCAL CODE REQUIREMENTS AND/OR PROJECT SPECIFICATIONS. THESE COMPONENTS SHOULD BE REVIEWED AND APPROVED BY A LICENSED DESIGN PROFESSIONAL.
4. JM TPO EDGE SEALANT IS REQUIRED ON ALL CUT OR NON-ENCAPSULATED EDGES OF REINFORCED MEMBRANE. THIS INCLUDES FACTORY CUT MEMBRANE (SEE DETAIL T-MS-01)

DRAWING NO.

T-DV-05

REPLACES TF-58B

SCALE
N.T.S

ISSUE DATE
7-17-17

LOW WALL PRIMARY SCUPPER FLASHING

MEMBRANE TYPE:
JM TPO

MAXIMUM GUARANTEE TERM:
30 YEAR

Johns Manville is a manufacturer of commercial roofing products and offers this general conceptual information to you as a courtesy. This complimentary assistance is not to be used or relied upon by anyone as a substitute for professional engineering design and documentation required by building code, contract, or applicable law. By accepting these comments you agree they do not constitute any representations, endorsements of, or an assumption by Johns Manville of any liability for either the adequacy of the design of this building or any other material not supplied by Johns Manville.

