

STEP 1 OF 4

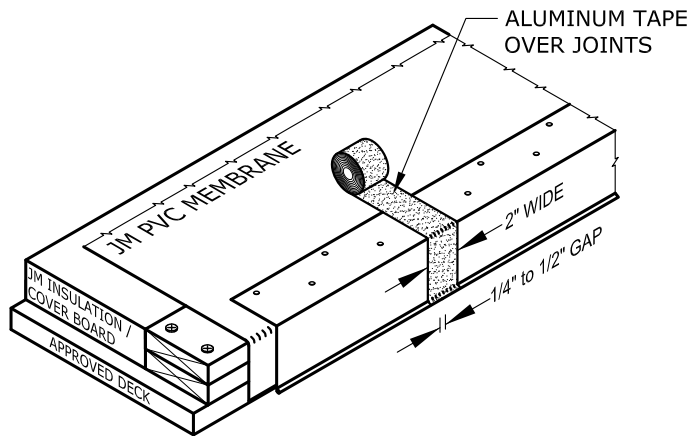

STEP 2 OF 4

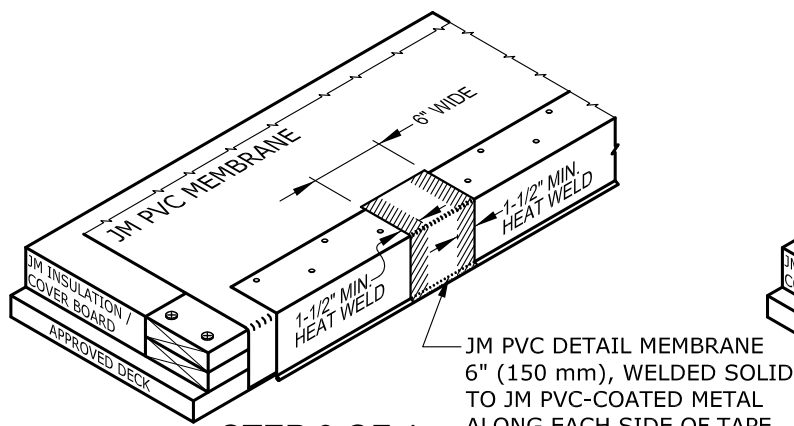

STEP 3 OF 4

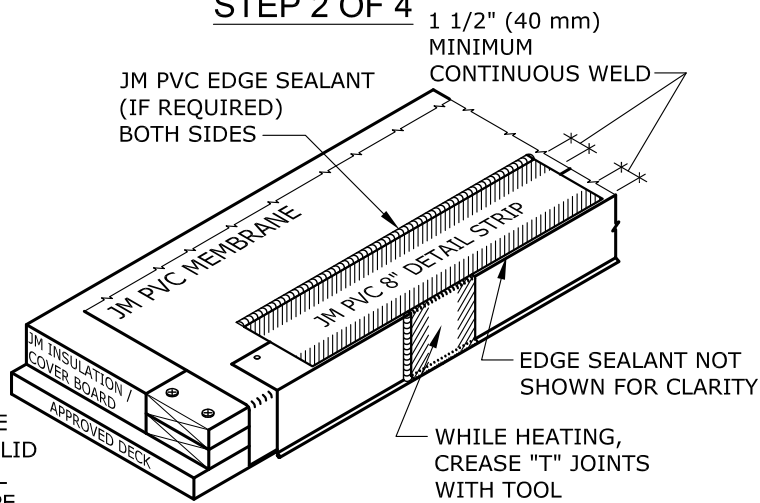

STEP 4 OF 4

JM PVC DETAIL MEMBRANE  
6" (150 mm) STRIP, WELDED  
SOLID TO JM PVC-COATED METAL  
ALONG EACH SIDE OF TAPE

PVC COATED  
METAL

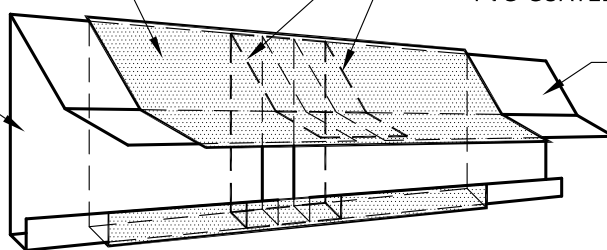

GRAVEL STOP

ALUMINUM TAPE COVERING ENTIRE  
LENGTH OF 1/4" (7 mm) MINIMUM TO  
1/2" (15 mm) MAXIMUM WIDTH JM  
PVC-COATED METAL JOINT

PVC COATED  
METAL

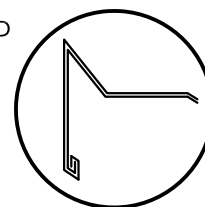

PROFILE VIEW

NOTES:

1. REFER TO JOHNS MANVILLE WEBSITE ([www.jm.com](http://www.jm.com)) FOR MOST UP-TO-DATE INFORMATION.
2. PLEASE SEE SINGLE PLY FLASHING SPECIFICATIONS FOR A FULL DESCRIPTION OF INSTALLATION INSTRUCTIONS AND REQUIREMENTS WHICH ARE CONSIDERED A PART OF THIS DETAIL.
3. ANY CARPENTRY OR METAL WORK SHOULD BE DESIGNED AND CONSTRUCTED IN ACCORDANCE WITH LOCAL CODE REQUIREMENTS AND/OR PROJECT SPECIFICATIONS. THESE COMPONENTS SHOULD BE REVIEWED AND APPROVED BY A LICENSED DESIGN PROFESSIONAL.
4. JM PVC EDGE SEALANT IS OPTIONAL ON CUT OR NON ENCAPSULATED EDGES OF PVC REINFORCED MEMBRANE. THIS INCLUDES FACTORY CUT MEMBRANE.

DRAWING NO.

**P-FE-CM6**

FLASHING EDGE

SCALE  
N.T.S

ISSUE DATE  
05-16-25

MEMBRANE TYPE:  
JM PVC

MAXIMUM GUARANTEE TERM:  
30 YEAR

## BUTT JOINT AT EDGE (PVC COATED METAL)

Johns Manville is a manufacturer of commercial roofing products and offers this general conceptual information to you as a courtesy for general educational purposes only. This complimentary assistance is not to be either used or relied upon by anyone as a substitute for professional engineering design and documentation required by any building code, contract, or applicable law. By accepting the general conceptual information, you agree it does not constitute any representations, endorsements of, or an assumption by Johns Manville of any duty or liability for either the adequacy of the design of a building, any of its components or the sufficiency of any construction.

