

JM RSUA (ROOFING SYSTEMS URETHANE ADHESIVE) IS APPLIED TO THE SUBSTRATE ON HORIZONTAL SURFACES, AND TO THE BACK OF THE MEMBRANE FOR VERTICAL SURFACES. IMMEDIATELY AFTER APPLYING THE FINAL RIBBONS OF RSUA ONTO THE HORIZONTAL SUBSTRATE, SET A WOOD 2 X INTO THE CORNER AND PUSH THE MEMBRANE TIGHT INTO THE CORNER. DO NOT FOLD OR CREASE THE MEMBRANE. APPLY RIBBONS OF RSUA ONTO THE BACK SIDE OF THE VERTICAL MEMBRANE AND AFTER THE PROPER REQUIRED LOCK DOWN/TACK FREE TIME APPLY THE MEMBRANE TO THE VERTICAL SUBSTRATE AND SMOOTH IN BY HAND THEN BROOM OR ROLL IT IN. SEE THE JM ROOFING SYSTEMS URETHANE ADHESIVE INSTALLATION INSTRUCTIONS FOR FURTHER INFORMATION.

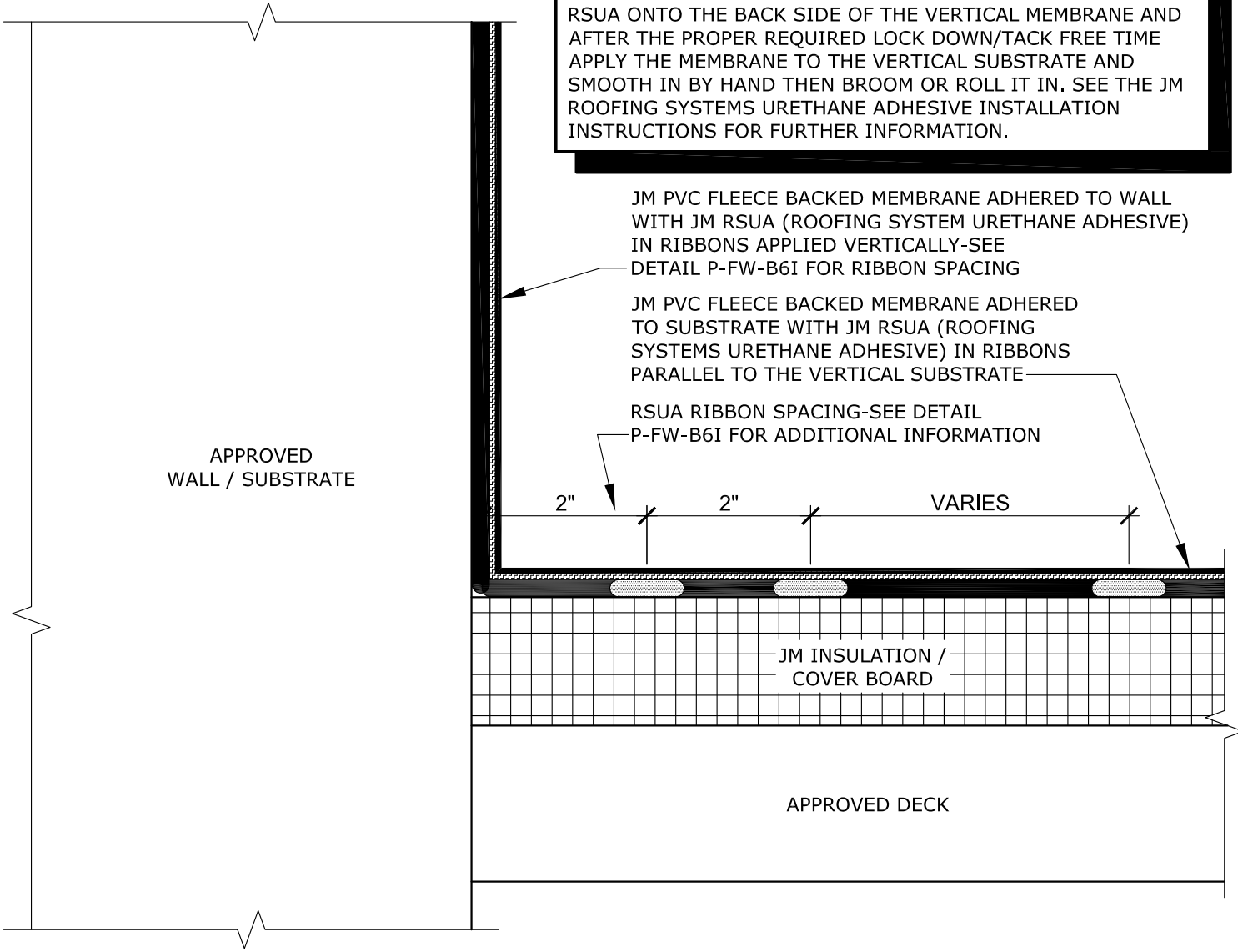

JM PVC FLEECE BACKED MEMBRANE ADHERED TO WALL WITH JM RSUA (ROOFING SYSTEM URETHANE ADHESIVE) IN RIBBONS APPLIED VERTICALLY-SEE DETAIL P-FW-B6I FOR RIBBON SPACING

JM PVC FLEECE BACKED MEMBRANE ADHERED TO SUBSTRATE WITH JM RSUA (ROOFING SYSTEMS URETHANE ADHESIVE) IN RIBBONS PARALLEL TO THE VERTICAL SUBSTRATE

RSUA RIBBON SPACING-SEE DETAIL P-FW-B6I FOR ADDITIONAL INFORMATION

APPROVED WALL / SUBSTRATE

2" 2" VARIES

JM INSULATION / COVER BOARD

APPROVED DECK

NOTES:

1. REFER TO JOHNS MANVILLE WEBSITE (www.jm.com) FOR MOST UP-TO-DATE INFORMATION.
2. PLEASE SEE SINGLE PLY FLASHING SPECIFICATIONS FOR A FULL DESCRIPTION OF INSTALLATION INSTRUCTIONS AND REQUIREMENTS WHICH ARE CONSIDERED A PART OF THIS DETAIL.
3. ANY CARPENTRY OR METAL WORK SHOULD BE DESIGNED AND CONSTRUCTED IN ACCORDANCE WITH LOCAL CODE REQUIREMENTS AND/OR PROJECT SPECIFICATIONS. THESE COMPONENTS SHOULD BE REVIEWED AND APPROVED BY A LICENSED DESIGN PROFESSIONAL.
4. FOR JM APPROVED INTERMEDIATE FLASHING FASTENING METHODS SEE P-FW-I DETAILS. INTERMEDIATE ADHERED MEMBRANE FASTENING REQUIRED AT 5'-0" (1.52 m) INTERVALS MAXIMUM, SEE DETAIL P-FW-M2I FOR JM APPROVED FASTENING METHODS.
5. PLEASE SEE DETAIL P-FW-B6I FOR ADDITIONAL INSTALLATION INFORMATION.
6. JM PVC EDGE SEALANT IS OPTIONAL ON CUT OR NON ENCAPSULATED EDGES OF PVC REINFORCED MEMBRANE. THIS INCLUDES FACTORY CUT MEMBRANE.

| | |
|----------------|------------|
| DRAWING NO. | |
| P-FW-B6 | |
| FLASHING WALL | |
| SCALE | ISSUE DATE |
| N.T.S | 08-07-19 |

| | |
|--|--|
| BASE TIE-IN FLEECE BACKED PVC IN RSUA | |
| MEMBRANE TYPE: PVC FLEECE BACKED | |
| MAXIMUM GUARANTEE TERM: | |

Johns Manville is a manufacturer of commercial roofing products and offers this general conceptual information to you as a courtesy. This complimentary assistance is not to be used or relied upon by anyone as a substitute for professional engineering design and documentation required by building code, contract, or applicable law. By accepting these comments you agree they do not constitute any representations, endorsements of, or an assumption by Johns Manville of any liability for either the adequacy of the design of this building or any other material not supplied by Johns Manville.

