

VERTICAL SURFACES
STEPS A & B

USE THIS DETAIL IN CONJUNCTION WITH DETAILS SPL-FP-05/06 WHICH IS PART OF THIS INSTALLATION.

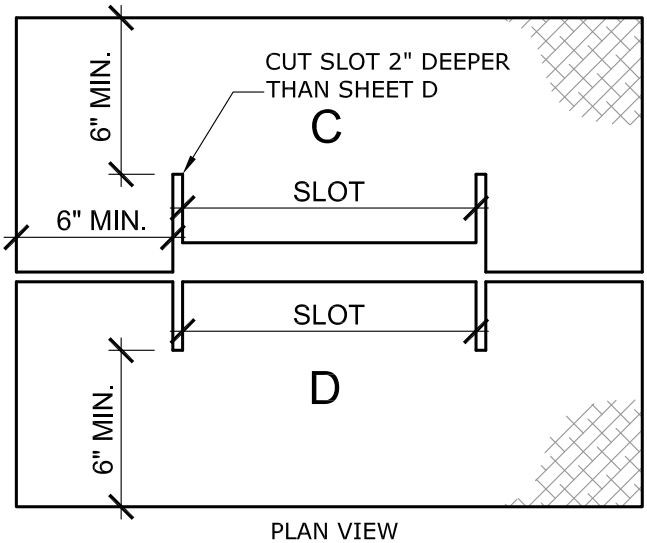
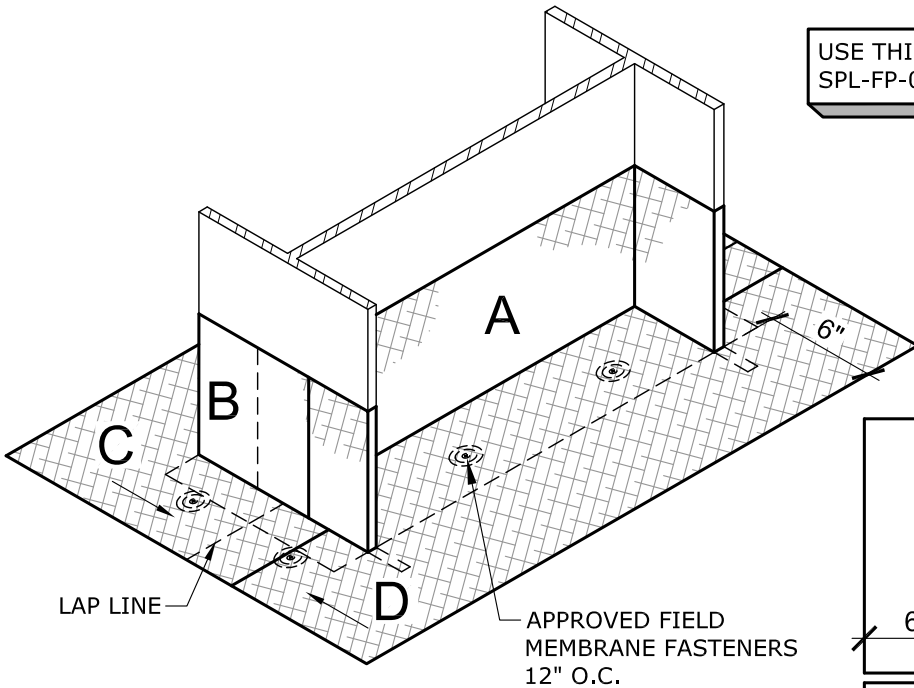

HORIZONTAL SURFACES
STEPS C & D

NOTES:

- ALL FOLD LINES SHOWN AS:
 ALL CUT LINES SHOWN AS: - - - -

DRAWING NO.

SPL-FP-07

WIDE FLANGE FLASHING SCRIM LAYOUT

PENETRATION

MEMBRANE TYPE:
 JM SP LIQUID

SCALE
 N.T.S

ISSUE DATE
 04-17-20

MAXIMUM GUARANTEE TERM:
 N/A

Johns Manville is a manufacturer of commercial roofing products and offers this general conceptual information to you as a courtesy. This complimentary assistance is not to be used or relied upon by anyone as a substitute for professional engineering design and documentation required by building code, contract, or applicable law. By accepting these comments you agree they do not constitute any representations, endorsements of, or an assumption by Johns Manville of any liability for either the adequacy of the design of this building or any other material not supplied by Johns Manville.

