

ASSEMBLY

- ① MASK TARGET AREA ON ROOF MEMBRANE AND PENETRATION.
- ② CLEAN & PRIME ALL NON-POROUS AREAS (METAL, ETC.) REQUIRING LIQUID MEMBRANE WITH PERMAFLASH PRIMER.
- ③ APPLY 30 MIL. BASE COAT OF MBR FLASHING CEMENT WITHIN TARGET AREA. (A BRUSH WORKS BEST).
- ④ EMBED SCRIM(S) INTO WET BASE COAT OF MBR FLASHING CEMENT, 1/2" SHORT OF TARGET AREA.
- ⑤ IMMEDIATELY AFTER EMBEDDING THE SCRIM, APPLY 60 MIL. FINISH COAT OF MBR FLASHING CEMENT OVER SCRIM AND 1/2" BEYOND, ENSURING SCRIM IS COMPLETELY EMBEDDED.
- ⑥ REMOVE MASKING TAPE IMMEDIATELY AFTER APPLICATION OF FINISH COAT.

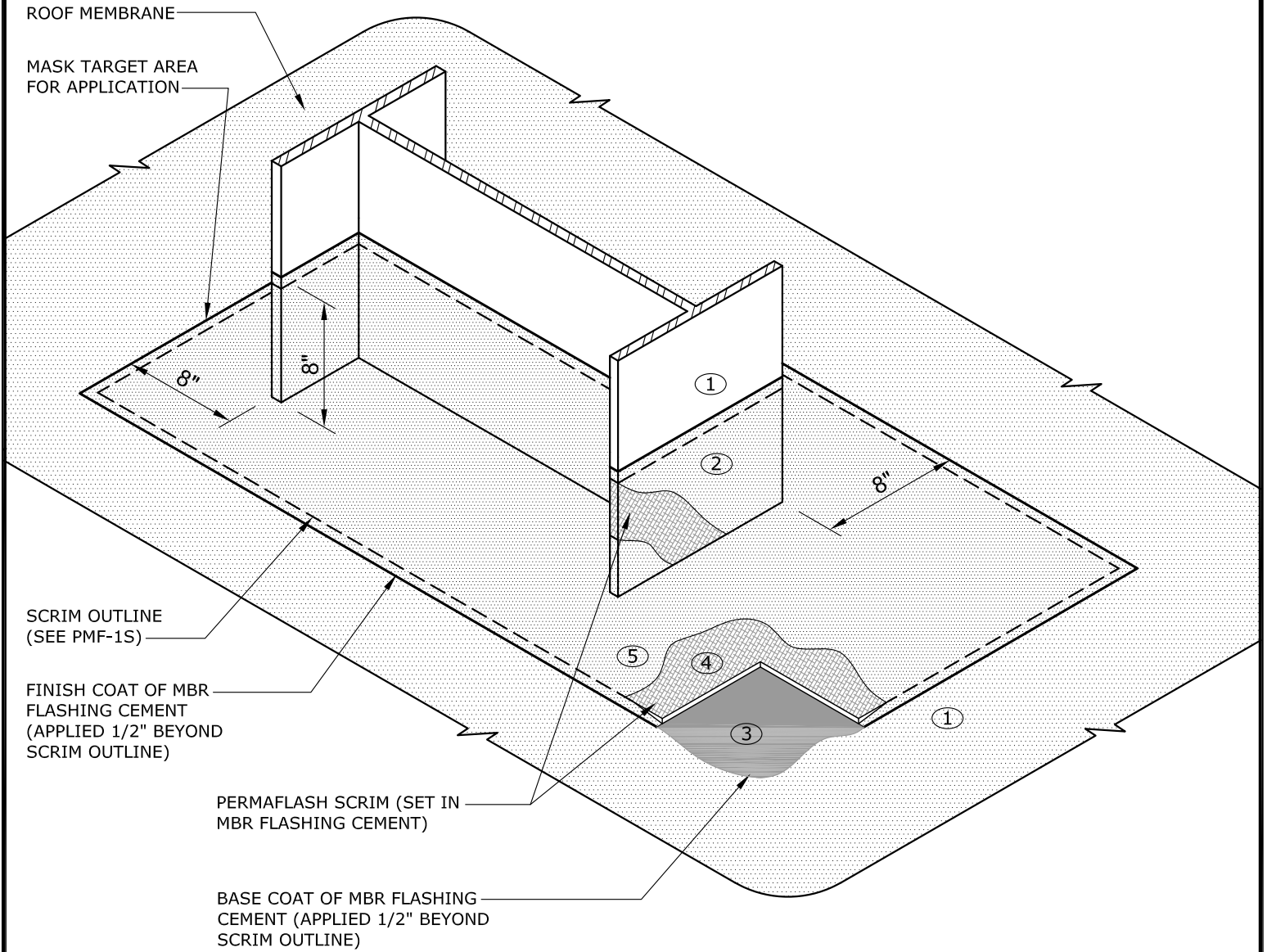

NOTES:

1. USE THIS DETAIL IN CONJUNCTION WITH THE PERMAFLASH I-BEAM SCRIM LAYOUT, DRAWING PMF-1S.
2. ENSURE TOTAL TARGET AREA OF FLASHING IS NO LESS THAN 16" x 16".
3. AN EXTRA COAT OF MBR FLASHING CEMENT MUST BE PLACED BETWEEN SCRIM LAYERS WHERE THEY OVERLAP TO ENSURE A PROPER BOND.
4. REFER TO PERMAFLASH APPLICATION INSTRUCTIONS FOR GENERAL GUIDELINES REGARDING THE PERMAFLASH SYSTEM.

DRAWING NO.		PERMAFLASH I-BEAM DETAIL		
PMF-1		MEMBRANE TYPE: PERMAFLASH		
SCALE	ISSUE DATE	MAXIMUM GUARANTEE TERM:		<small>Johns Manville is a manufacturer of commercial roofing products and offers this general conceptual information to you as a courtesy. This complimentary assistance is not to be used or relied upon by anyone as a substitute for professional engineering design and documentation required by building code, contract, or applicable law. By accepting these comments you agree they do not constitute any representations, endorsements of, or an assumption by Johns Manville of any liability for either the adequacy of the design of this building or any other material not supplied by Johns Manville.</small>
N.T.S	5-1-17			