

FACEPLATE ON EXTERIOR WALL

(SEE SECTION BELOW) SLIDE FACEPLATE OVER SCUPPER SLEEVE

TOP HEM FILLED WITH CAULK, SEAL ALL SIDES

GALVANIZED METAL FACE PLATE INSTALLED OVER SCUPPER SLEEVE PINNED & SEALED TO EXTERIOR WALL

TERMINATE TOP OF BASE FLASHINGS AS SPECIFIED

8" MIN. TO 24" MAX. BASE FLASHING HT.

SMOOTH SBS OR APP TARGET PATCH BEHIND SCUPPER ADHERED

APPROVED SBS OR APP FLASHING (EXTEND OVER SCUPPER)

SCUPPER SLEEVE THROUGH WALL
 ASPHALT PRIMER
 JM FESCANT PLUS
 WOOD NAILER SECURED TO DECK UNDER SCUPPER FLANGE. (SHOWN OUTSIDE OF SUMP FOR CLARITY)

APPROVED SBS OR APP FLASHING
 3 COURSE ALL EDGES OF OUTER FLASHING AT SCUPPER W/ MBR UTILITY CEMENT

SOLDERED SCUPPER
 SET FLANGE INTO BED OF MBR UTILITY CEMENT
 NAIL FLANGE OF SCUPPER THROUGH BASE FLASHING AND ALL PLIES OF ROOF INTO WOOD NAILER BELOW WITH RING SHANK NAILS

4" MIN.

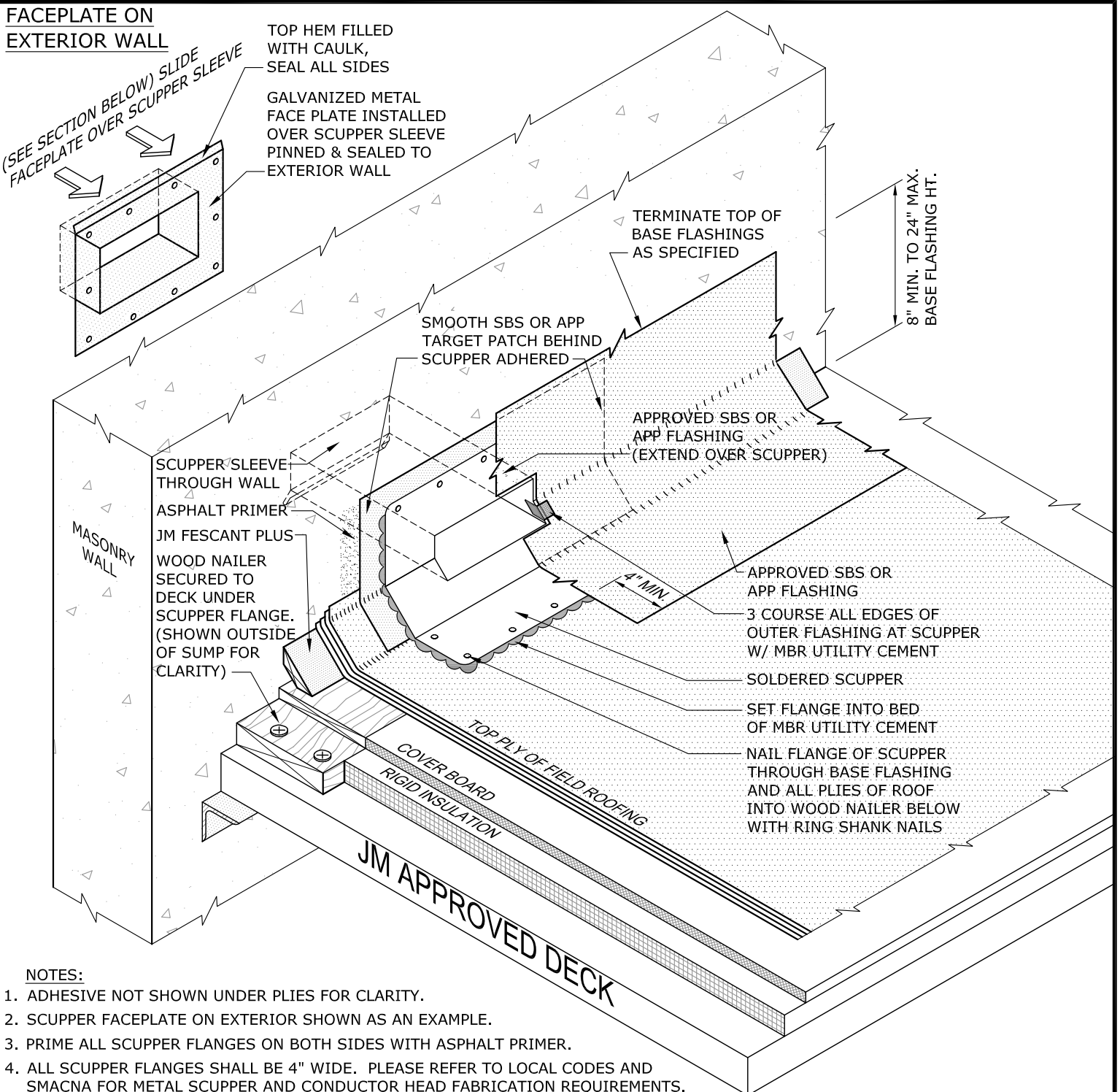

NOTES:

1. ADHESIVE NOT SHOWN UNDER PLIES FOR CLARITY.
2. SCUPPER FACEPLATE ON EXTERIOR SHOWN AS AN EXAMPLE.
3. PRIME ALL SCUPPER FLANGES ON BOTH SIDES WITH ASPHALT PRIMER.
4. ALL SCUPPER FLANGES SHALL BE 4" WIDE. PLEASE REFER TO LOCAL CODES AND SMACNA FOR METAL SCUPPER AND CONDUCTOR HEAD FABRICATION REQUIREMENTS.
5. ANY CARPENTRY, METAL WORK, OR MASONRY CONSTRUCTION SHOULD BE DESIGNED AND CONSTRUCTED IN ACCORDANCE WITH LOCAL CODE REQUIREMENTS AND/OR PROJECT SPECIFICATIONS. THESE COMPONENTS SHOULD BE REVIEWED AND APPROVED BY A LICENSED DESIGN PROFESSIONAL.
6. PLEASE SEE BITUMINOUS FLASHING SPECIFICATIONS FOR A FULL DESCRIPTION OF INSTALLATION INSTRUCTIONS AND REQUIREMENTS WHICH ARE CONSIDERED A PART OF THIS DETAIL.
7. SBS HEAT WELDED FLASHINGS CAN ONLY BE USED WITH SBS OR BUR SYSTEMS. APP HEAT WELDED FLASHINGS CAN ONLY BE USED WITH APP OR BUR SYSTEMS. (PLEASE REFER TO THE APPROPRIATE TABLE IN THE BITUMINOUS FLASHING SPECIFICATION INDICATING ACCEPTABLE FLASHING PRODUCTS FOR EACH OF THE SBS OR APP HEAT WELDED SYSTEMS.)
8. CAUTION: IMPROPER USE OF THESE MATERIALS AND APPLICATION EQUIPMENT CAN RESULT IN SEVERE BURNS, AND/ OR DAMAGE TO PROPERTY. THE MECHANIC MUST INSTALL THESE MATERIALS USING THE TECHNIQUES RECOMMENDED BY JM AND THOSE FOUND IN THE CERTIFIED ROOFING TORCH APPLICATOR (CERTA) PROGRAM AVAILABLE THROUGH THE NATIONAL ROOFING CONTRACTORS ASSOCIATION.

DRAWING NO.

HW-22

DRAINS & VENTS

OVERFLOW METAL SCUPPER

MEMBRANE TYPE:
 BUR

SCALE
 N.T.S

ISSUE DATE
 09-11-24

MAXIMUM GUARANTEE TERM:

Johns Manville is a manufacturer of commercial roofing products and offers this general conceptual information to you as a courtesy for general educational purposes only. This complimentary assistance is not to be either used or relied upon by anyone as a substitute for professional engineering design and documentation required by any building code, contract, or applicable law. By accepting the general conceptual information, you agree it does not constitute any representations, endorsements of, or an assumption by Johns Manville of any duty or liability for either the adequacy of the design of a building, any of its components or the sufficiency of any construction.

