

# JM CladStone™ Water & Fire Block

## Continuous Insulation for Rain-Screen Cladding Systems

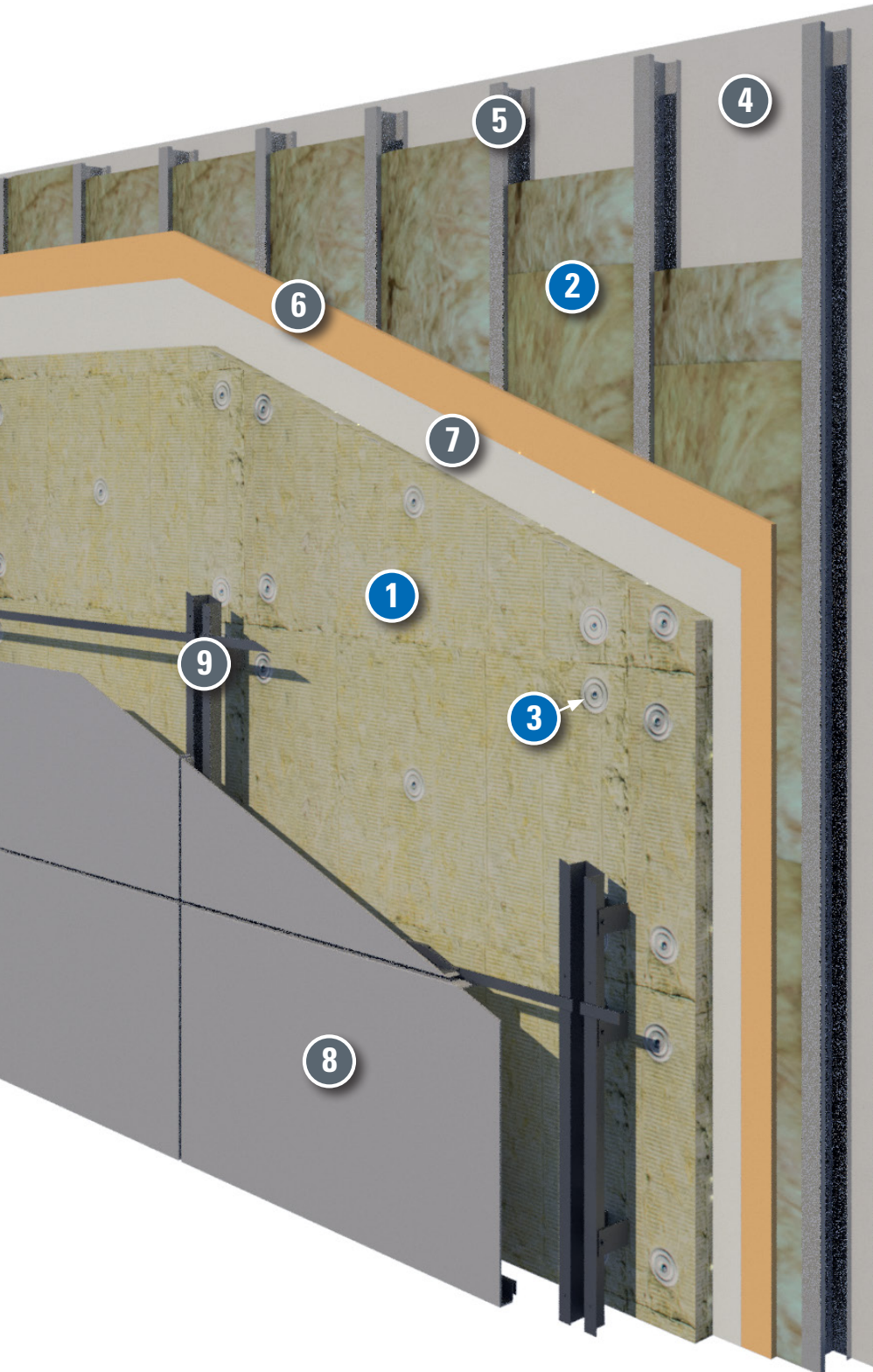

- 1** JM CladStone™ Water & Fire Block
- 2** Cavity Insulation<sup>1</sup>  
Options include batts and rolls, blow-in, mineral wool, spray foam, hybrid or empty.
- 3** Mechanical Fastener<sup>2</sup>
- 4** Interior Wall Board
- 5** Concrete, Concrete Masonry Unit, Steel Stud or Wood
- 6** Exterior Sheathing
- 7** Independent Air and Water-Resistive Barrier
- 8** Exterior Cladding – Metal Panels
- 9** Exterior Cladding Attachment System

<sup>1</sup> Insulation materials available from JM.

<sup>2</sup> Attachment method may vary depending on wall assembly components and local building code requirements.

\* Wall assembly is for reference only and not to be used as a substitute for professional engineering design and documentation required by building code, contract, or applicable laws.