

Bituminous Flashings Specification CR-5

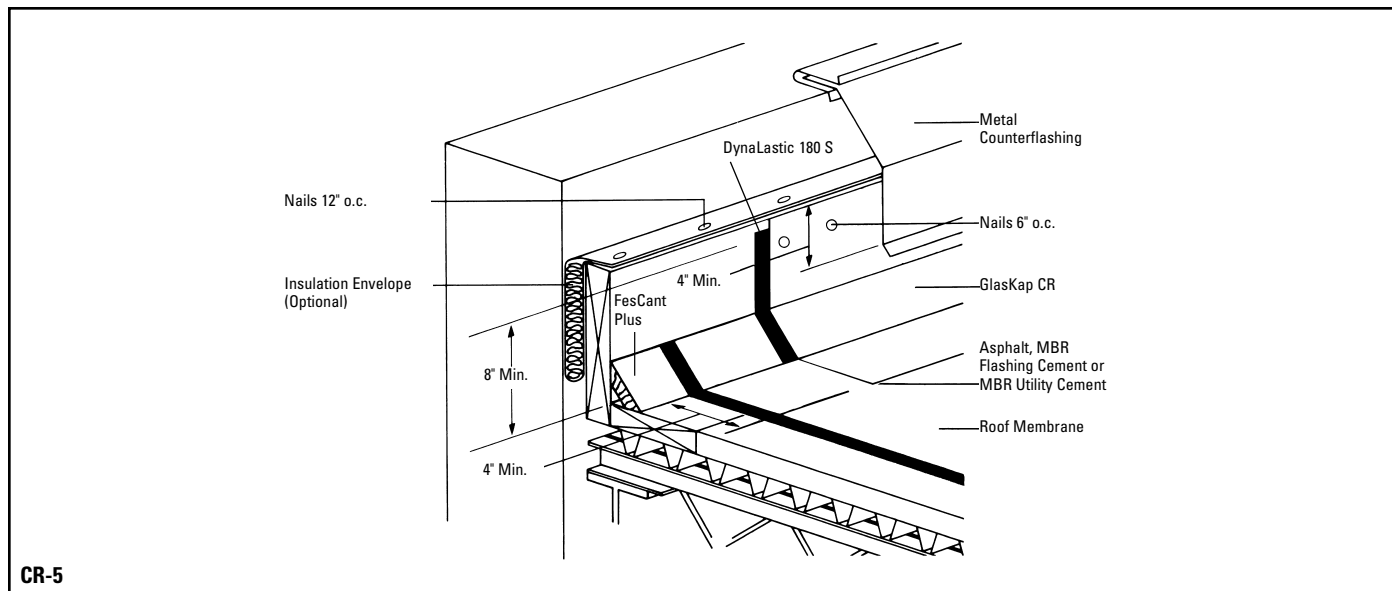

Base Flashing

For non-load-bearing construction (alternate)
[See also CR-1 (NLB)]

General

This flashing specification is an alternate detail to CR-1 (NLB) for use on non load-bearing construction, or where there is any potential for differential movement between the deck and the parapet or wall. **The vertical wood curb should be fastened to the deck only.**

Note: All general instructions contained in the current JM Commercial/Industrial Roofing Systems Manual are to be considered part of this specification.

Preparation for Flashing: Any previously installed metal cap or counterflashing must be lifted or removed, to permit application of the expansion joint cover.

Application

Base Flashing: Refer to Flashing Specification CR-1 (NLB) for detailed instructions on application of the base flashing.

Metal Cap Flashing: The metal flashing should be installed in accordance with the metal manufacturer's specifications and details, or in accordance with SMACNA procedures. It should overlap the base flashing a minimum of 4" (102 mm).

Surfacing: GlasKap CR requires no additional surfacing.

Note: For the most current information on general guidelines, please refer to the System Considerations tab under Systems Introduction & Selection on the JM Roofing Web site. For specifications, flashing details and general installation information please refer to the System Application tab.

Refer to the Material Safety Data Sheet and product label prior to using this product.