

INSTALL JM POLYESTER REINFORCED BACKER PLY DOWN OVER CANT STRIP AND AROUND CORNER AS SHOWN - BACKER PLY COMING FROM OPPOSITE DIRECTION NOT SHOWN FOR CLARITY

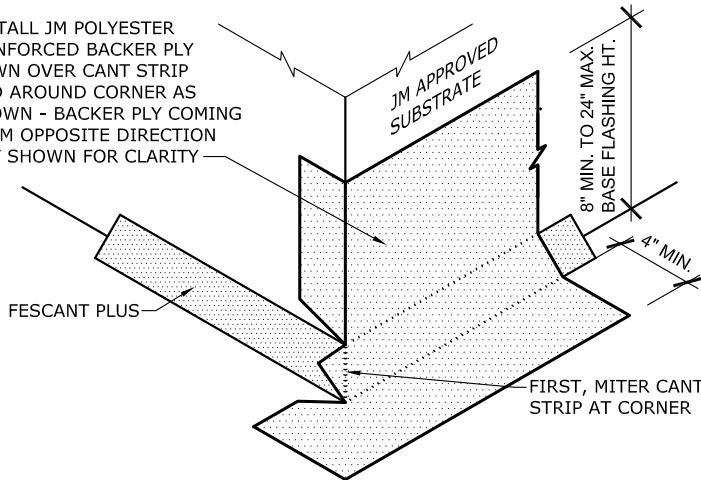

STEP 1

INSTALL CAP SHEET OVER BACKER PLY AS SHOWN

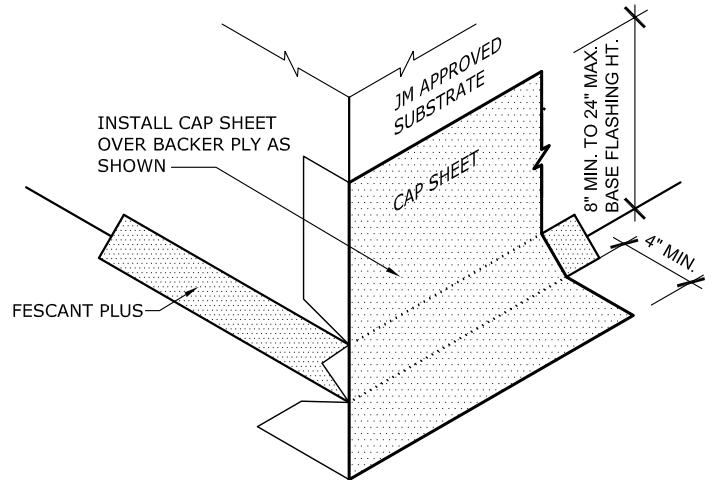

STEP 2

INSTALL CAP SHEET OVER BACKER PLY AS SHOWN

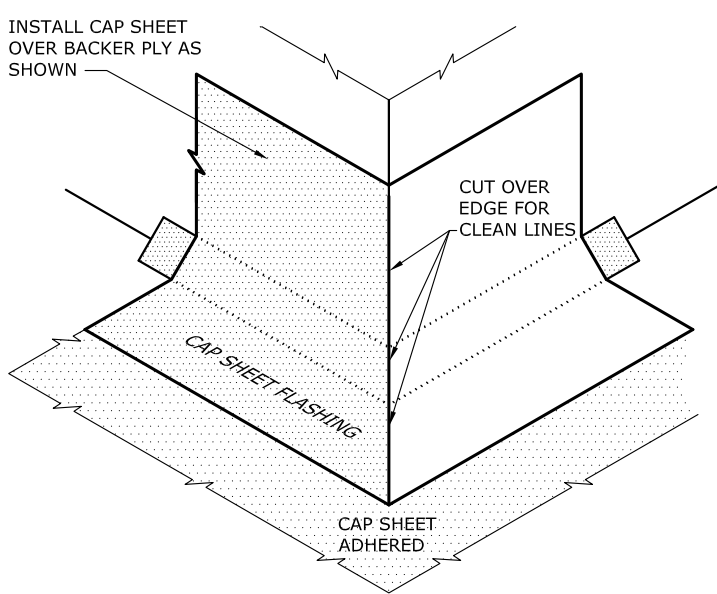

STEP 3

3 COURSING OF MBR UTILITY CEMENT & FABRIC OR MBR FLASHING CEMENT & FABRIC

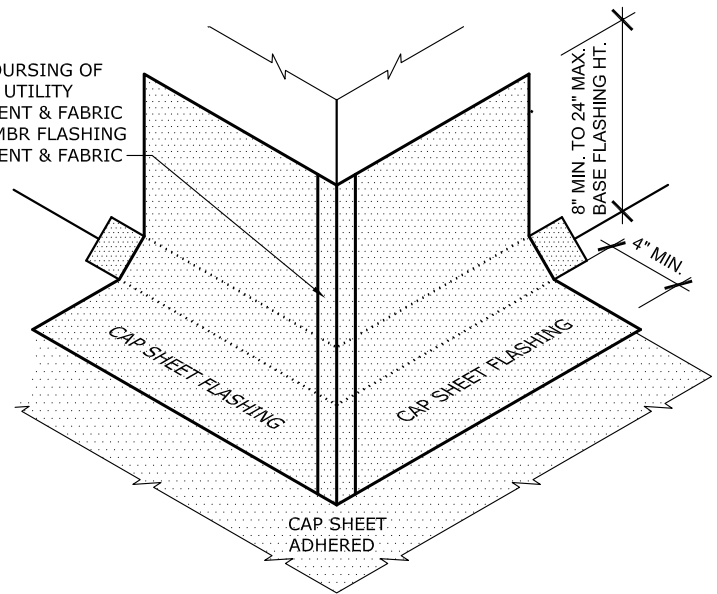

STEP 4

NOTES:

1. REFER TO JOHNS MANVILLE WEBSITE (www.jm.com) FOR MOST UP-TO-DATE INFORMATION.
2. 3-COURSING WITH MBR UTILITY CEMENT & FABRIC OR MBR FLASHING CEMENT & FABRIC MUST BE USED ALONG EDGE OF BASE FLASHING AS DEPICTED IN STEP 4.
3. VERTICAL JOINTS ARE TO BE OVERLAPPED 4" MINIMUM FOR ALL APPLICATIONS. 3 COURSING WITH MBR UTILITY CEMENT AND FABRIC OR JM MBR FLASHING CEMENT IS RECOMMENDED ON ALL VERTICAL FLASHING LAPS AND INSIDE/OUTSIDE CORNERS EXTENDING PAST LEADING EDGE OF CANT STRIP.
4. PLEASE SEE BITUMINOUS FLASHING SPECIFICATIONS FOR A FULL DESCRIPTION OF INSTALLATION INSTRUCTIONS AND REQUIREMENTS WHICH ARE CONSIDERED A PART OF THIS DETAIL.
5. JM POLYESTER REINFORCED BACKER PLY INCLUDES DYNABASE PR OR DYNALASTIC 180 S.
6. MASONRY SUBSTRATES REQUIRE PRIMING WITH ASPHALT PRIMER PRIOR TO BACKER PLY INSTALLATION. WOOD SUBSTRATES REQUIRE A MECHANICALLY FASTENED BACKER PLY FASTENED 9" O.C. IN BOTH DIRECTIONS.

DRAWING NO.

BIT-26

CURB & CORNER

SCALE
N.T.S

ISSUE DATE
07-08-21

BASE FLASHING AT OUTSIDE CORNER

MEMBRANE TYPE:
BUR

MAXIMUM GUARANTEE TERM:

Johns Manville is a manufacturer of commercial roofing products and offers this general conceptual information to you as a courtesy for general educational purposes only. This complimentary assistance is not to be either used or relied upon by anyone as a substitute for professional engineering design and documentation required by any building code, contract, or applicable law. By accepting the general conceptual information, you agree it does not constitute any representations, endorsements of, or an assumption by Johns Manville of any duty or liability for either the adequacy of the design of a building, any of its components or the sufficiency of any construction.

