

**NOTE:**  
 JM EPDM TAPE PRIMER OR JM SINGLE PLY MEMBRANE PRIMER (LOW VOC) MUST BE APPLIED TO ALL SURFACES COMING INTO CONTACT WITH JM EPDM PEEL & STICK FLASHINGS

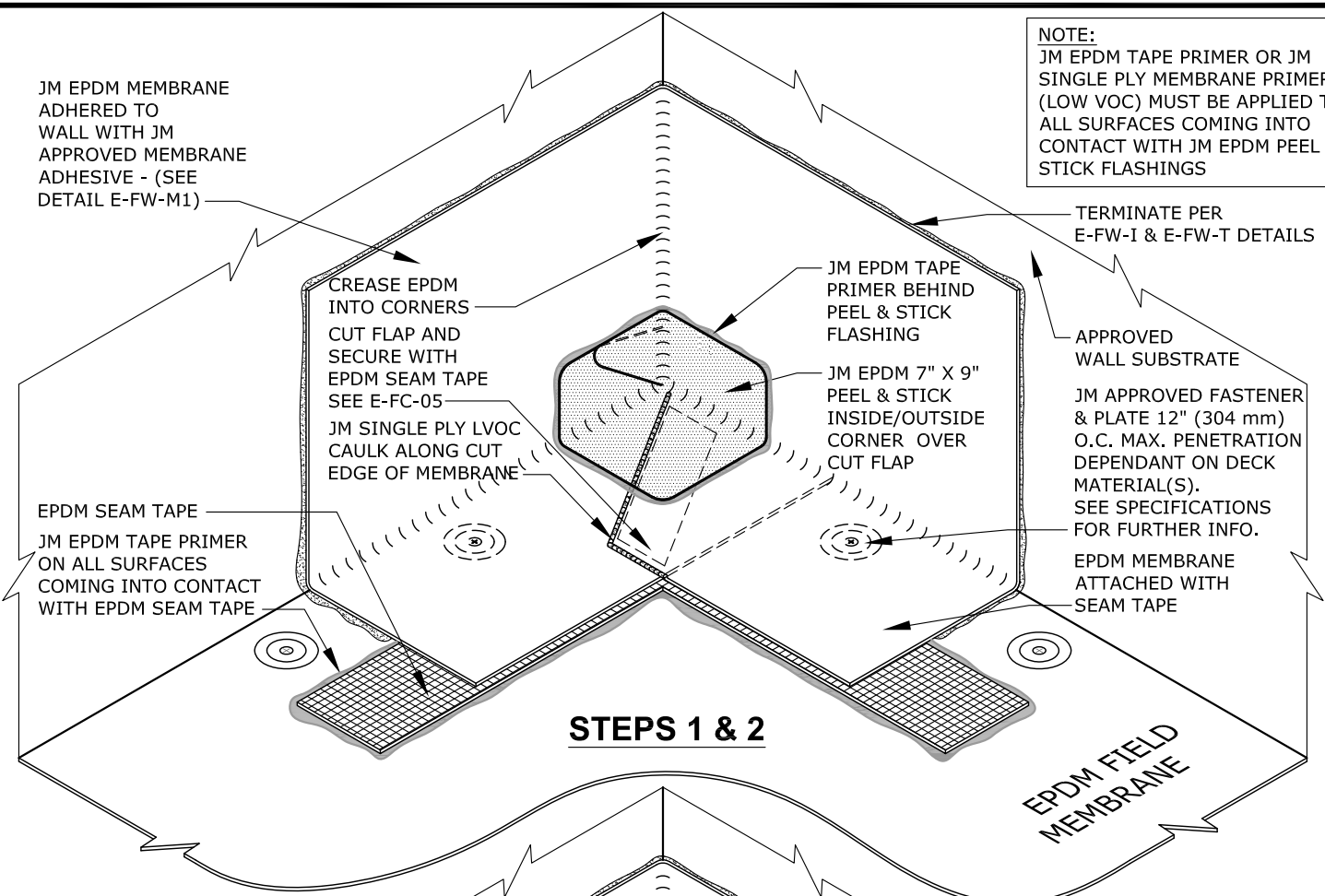

**STEPS 1 & 2**

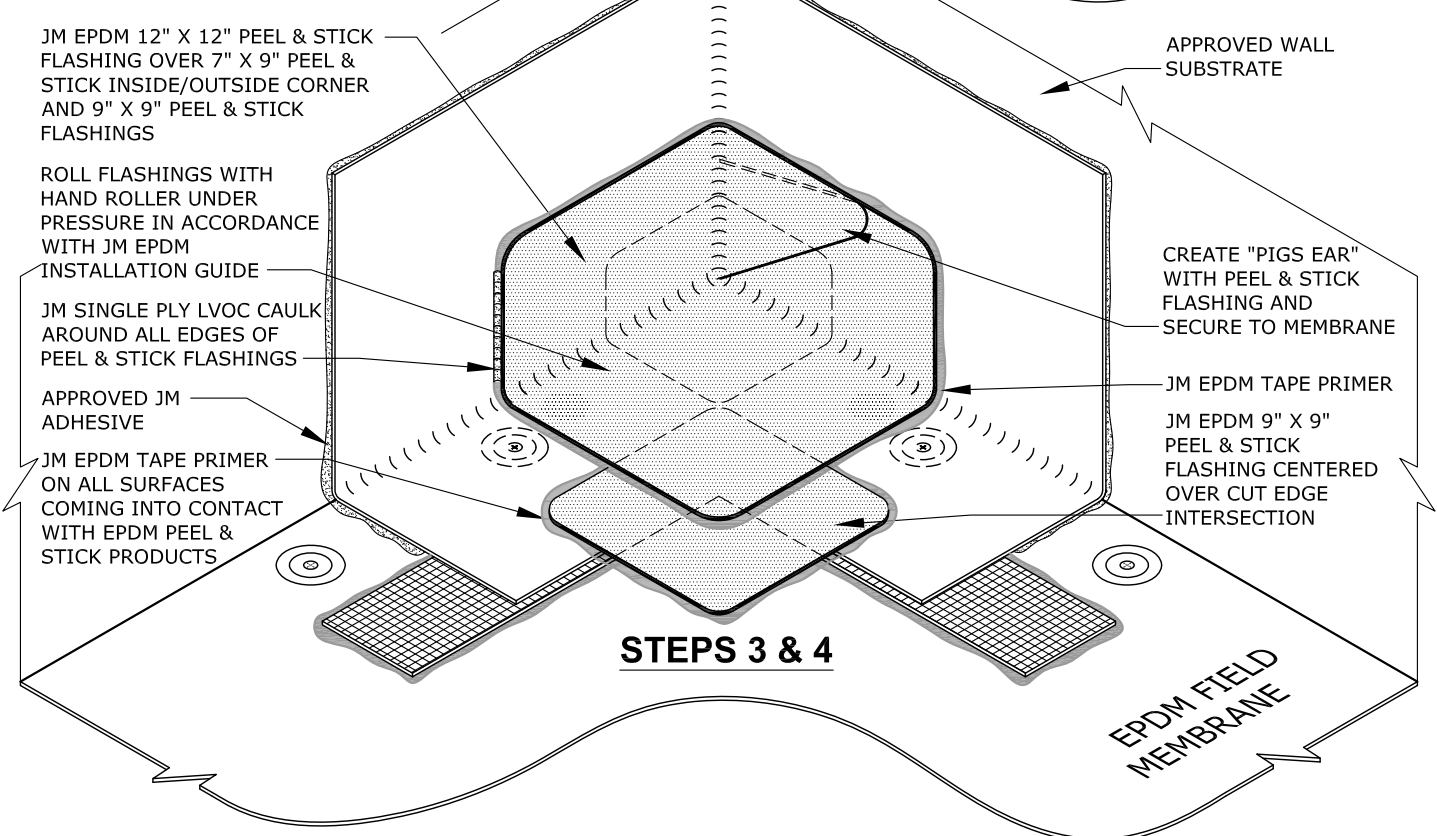

**STEPS 3 & 4**

DRAWING NO.  
**E-FC-06**  
 NEW DETAIL  
 SCALE  
 N.T.S

**EPDM INSIDE CORNER WITH SEAM TAPE 30 YEAR**  
 MEMBRANE TYPE:  
 JM EPDM  
 MAXIMUM GUARANTEE TERM:  
 30 YEAR

Johns Manville is a manufacturer of commercial roofing products and offers this general conceptual information to you as a courtesy. This complimentary assistance is not to be used or relied upon by anyone as a substitute for professional engineering design and documentation required by building code, contract, or applicable law. By accepting these comments you agree they do not constitute any representations, endorsements of, or an assumption by Johns Manville of any liability for either the adequacy of the design of this building or any other material not supplied by Johns Manville.

