

STEP 1

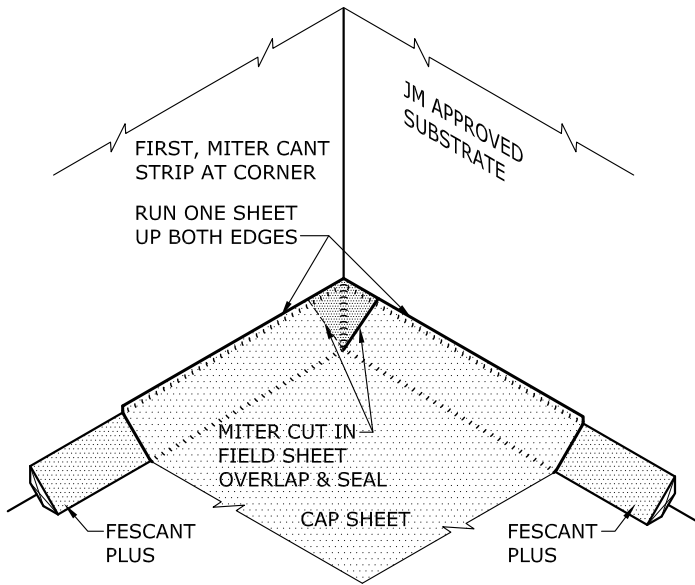

STEP 2

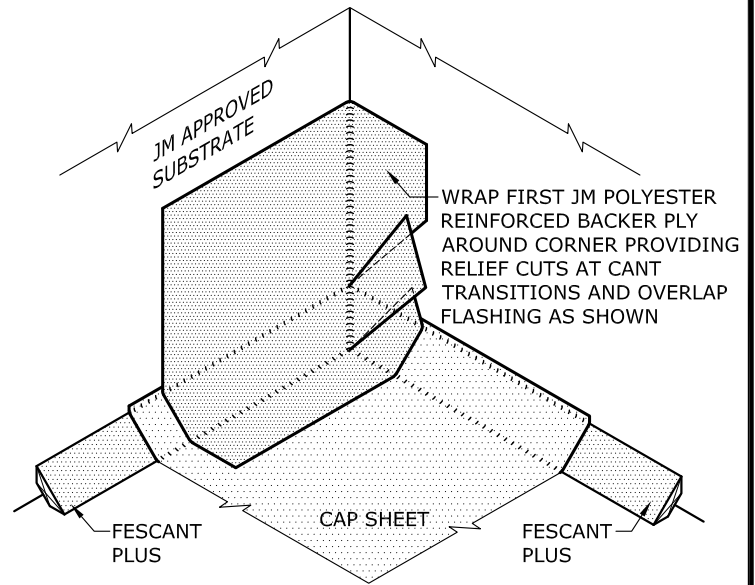

STEP 3

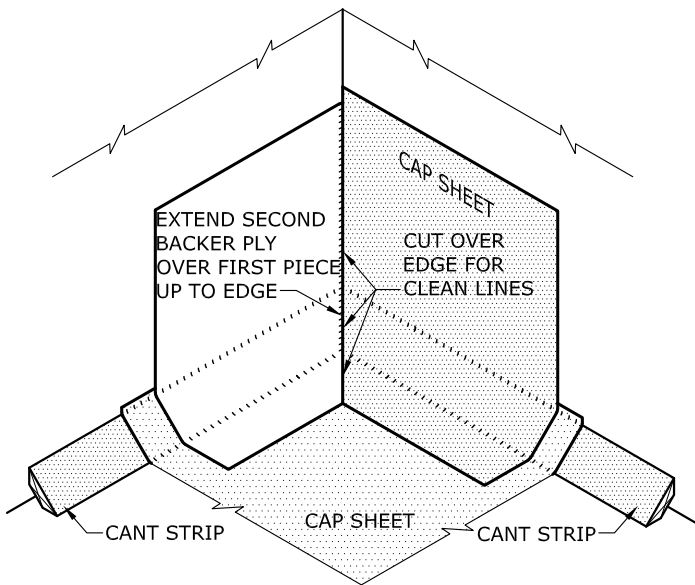

STEP 4

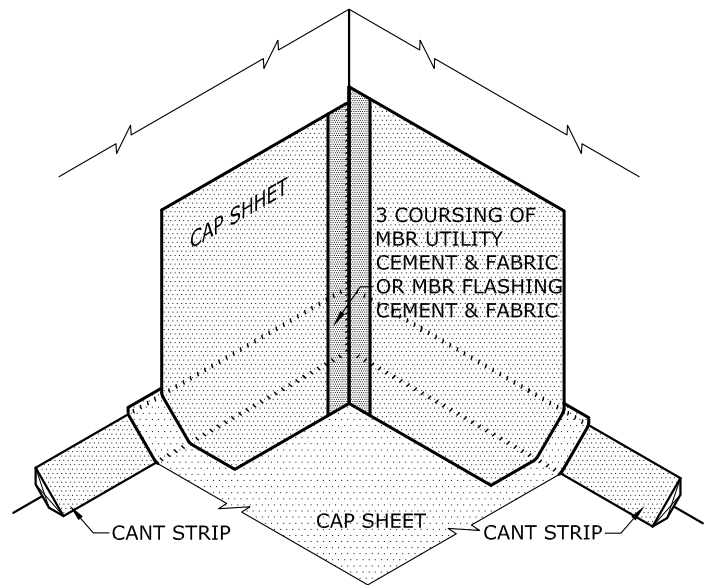

NOTES:

1. REFER TO JOHNS MANVILLE WEBSITE (www.jm.com) FOR MOST UP-TO-DATE INFORMATION.
2. 3-COURSING WITH MBR UTILITY CEMENT & FABRIC OR MBR FLASHING CEMENT & FABRIC MUST BE USED ALONG EDGE OF BASE FLASHING AS DEPICTED IN STEP 4.
3. VERTICAL JOINTS ARE TO BE OVERLAPPED 4" MINIMUM FOR ALL APPLICATIONS. 3 COURSING WITH MBR UTILITY CEMENT AND FABRIC OR JM MBR FLASHING CEMENT IS RECOMMENDED ON ALL VERTICAL FLASHING LAPS AND INSIDE/OUTSIDE CORNERS EXTENDING PAST LEADING EDGE OF CANT STRIP.
4. PLEASE SEE BITUMINOUS FLASHING SPECIFICATIONS FOR A FULL DESCRIPTION OF INSTALLATION INSTRUCTIONS AND REQUIREMENTS WHICH ARE CONSIDERED A PART OF THIS DETAIL.
5. JM POLYESTER REINFORCED BACKER PLY INCLUDES DYNABASE PR OR DYNALASTIC 180 S.
6. MASONRY SUBSTRATES REQUIRE PRIMING WITH ASPHALT PRIMER PRIOR TO BACKER PLY INSTALLATION. WOOD SUBSTRATES REQUIRE A MECHANICALLY FASTENED BACKER PLY FASTENED 9" O.C. IN BOTH DIRECTIONS.

DRAWING NO.

BIT-27

CURB & CORNER

BASE FLASHING AT INSIDE CORNER

MEMBRANE TYPE:
BUR

MAXIMUM GUARANTEE TERM:

SCALE: N.T.S.
ISSUE DATE: 02-06-19

Johns Manville is a manufacturer of commercial roofing products and offers this general conceptual information to you as a courtesy. This complimentary assistance is not to be used or relied upon by anyone as a substitute for professional engineering design and documentation required by building code, contract, or applicable law. By accepting these comments you agree they do not constitute any representations, endorsements of, or an assumption by Johns Manville of any liability for either the adequacy of the design of this building or any other material not supplied by Johns Manville.

