

JM RSUA (ROOFING SYSTEMS URETHANE ADHESIVE) IS APPLIED TO THE SUBSTRATE ON HORIZONTAL SURFACES, AND TO THE BACK OF THE MEMBRANE FOR VERTICAL SURFACES. IMMEDIATELY AFTER APPLYING THE FINAL RIBBONS OF RSUA ONTO THE HORIZONTAL SUBSTRATE, SET A WOOD 2 X INTO THE CORNER AND PUSH THE MEMBRANE TIGHT INTO THE CORNER. DO NOT FOLD OR CREASE THE MEMBRANE. APPLY RIBBONS OF RSUA ONTO THE BACK SIDE OF THE VERTICAL MEMBRANE AND AFTER THE PROPER REQUIRED LOCK DOWN/TACK FREE TIME APPLY THE MEMBRANE TO THE VERTICAL SUBSTRATE AND SMOOTH IN BY HAND THEN BROOM OR ROLL IT IN. SEE THE JM ROOFING SYSTEMS URETHANE ADHESIVE INSTALLATION INSTRUCTIONS FOR FURTHER INFORMATION.

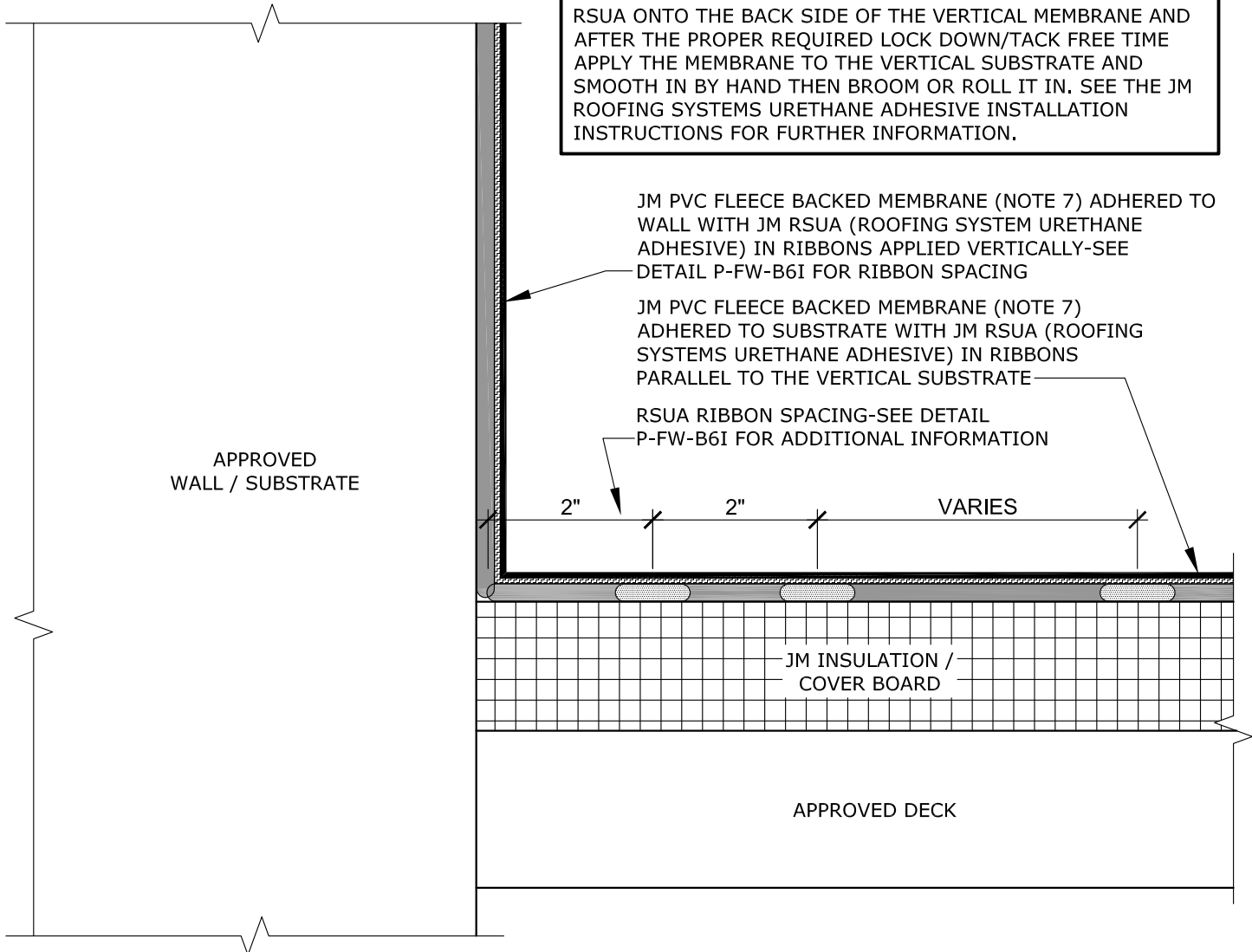

NOTES:

1. REFER TO JOHNS MANVILLE WEBSITE (www.jm.com) FOR MOST UP-TO-DATE INFORMATION.
2. PLEASE SEE SINGLE PLY FLASHING SPECIFICATIONS FOR A FULL DESCRIPTION OF INSTALLATION INSTRUCTIONS AND REQUIREMENTS WHICH ARE CONSIDERED A PART OF THIS DETAIL.
3. ANY CARPENTRY OR METAL WORK SHOULD BE DESIGNED AND CONSTRUCTED IN ACCORDANCE WITH LOCAL CODE REQUIREMENTS AND/OR PROJECT SPECIFICATIONS. THESE COMPONENTS SHOULD BE REVIEWED AND APPROVED BY A LICENSED DESIGN PROFESSIONAL.
4. FOR JM APPROVED INTERMEDIATE FLASHING FASTENING METHODS SEE P-FW-I DETAILS. INTERMEDIATE ADHERED MEMBRANE FASTENING REQUIRED AT 5'-0" (1.52 m) INTERVALS MAXIMUM, SEE DETAIL P-FW-M2I FOR JM APPROVED FASTENING METHODS.
5. PLEASE SEE DETAIL P-FW-B6I FOR ADDITIONAL INSTALLATION INFORMATION.
6. JM PVC EDGE SEALANT IS OPTIONAL ON CUT OR NON ENCAPSULATED EDGES OF PVC REINFORCED MEMBRANE. THIS INCLUDES FACTORY CUT MEMBRANE.
7. JM PVC FLEECE BACKED MEMBRANE OPTIONS INCLUDE JM PVC FB WITH DOW™ ELVOY® KEE POLMER AND JM PVC SD PLUS FB.

DRAWING NO.
P-FW-B6

BASE TIE-IN FLEECE BACKED PVC IN RSUA

FLASHING WALL
SCALE
N.T.S

MEMBRANE TYPE:
PVC FLEECE BACKED
MAXIMUM GUARANTEE TERM:

Johns Manville is a manufacturer of commercial roofing products and offers this general conceptual information to you as a courtesy for general educational purposes only. This complimentary assistance is not to be either used or relied upon by anyone as a substitute for professional engineering design and documentation required by any building code, contract, or applicable law. By accepting the general conceptual information, you agree it does not constitute any representations, endorsements of, or an assumption by Johns Manville of any duty or liability for either the adequacy of the design of a building, any of its components or the sufficiency of any construction.

